

SIDEWALK RAMPS

- TYPE A : GRASS BOULEVARD
- TYPE B : SIDEWALK ADJACENT TO STREET CURB
- TYPE C : CONTINUOUS CONCRETE IN BOULEVARD (TYPICALLY DOWNTOWN AREA)

LEGEND:

	DETECTABLE WARNING PANEL UNPAINTED CAST IRON
	GRASS
	COLORLED BRICK CONCRETE (MIN 2')
	UPPER LANDING 2% MAX
	LOWER LANDING 2% MAX
	0", 3", 4" OR 6" CURB HEIGHT
	1/2" EXPANSION (ALL EXPANSION SHALL BE SEALED WITH HOT POUR)
	20:1=5% 12:1=8.3% 10:1=10% 4:1=25%

- NOTES:**
- RAMP WIDTH IS DEFINED AS THE USEABLE PORTION OF THE RAMP, EXCLUDING FLARES IF USED. CURB RAMP WIDTH SHOULD MATCH THE EXISTING SIDEWALK WIDTH. 4' WIDTH MINIMUM. RAMP WIDTH FOR SHARED-USE PATHS SHOULD MATCH THE EXISTING SHARED USE PATH WIDTH.
 - RAMP LENGTH SHALL BE MAXIMUM OF 15'. ANY PORTIONS OF SIDEWALK BETWEEN THE DETECTABLE WARNING PANELS AND THE CURB SHALL HAVE A MAX 2% LONGITUDINAL GRADE.
 - LANDINGS SHALL BE A MINIMUM OF 4' X 4' AND SHALL HAVE A MAX 2% SLOPE IN ANY DIRECTION. LANDINGS ARE DESIRABLY 5' X 5' OR LARGER.
 - DETECTABLE WARNING PANELS SHALL MATCH THE RAMP WIDTH. RADIAL PANELS MAY ALSO BE USED. THE DETECTABLE WARNING PANEL MAY BE LOCATED WITHIN THE LOWER LANDING.
 - THE PEDESTRIAN ACCESS ROUTE SHALL BE CONTINUOUS 4' MIN. WIDTH. MAX 2% CROSS SLOPE APPLIES TO ALL CONCRETE, EXCLUDING FLARES.
 - LANDSCAPING IS PREFERRED TO MODIFY EXISTING GROUND SLOPE CHANGES AS NEEDED. IF NOT POSSIBLE, SUCH AS ADJACENT BUILDINGS, A VERTICAL CURB MAY BE USED AS SHOWN IN THE DETAIL BELOW. THE CURB WILL BE PAID FOR AT THE UNIT PRICE BID FOR THE ITEM "CURB - TYPE SW" PER LINEAL FOOT.
 - THE MAJORITY OF LINES SHOWN ON DETAILS INDICATE POINT OF DIFFERING GRADE CHANGES. ACTUAL JOINT DIMENSIONS MAY VARY IN FIELD.
 - LONGITUDINAL SLOPE ON SIDEWALK SHALL NOT EXCEED 5%. GENERALLY SIDEWALK GRADE IS ESTABLISHED BY THE ROADWAY GRADE. SIDEWALK SHALL NOT EXCEED 2% CROSS SLOPE.
 - CONCRETE LANDINGS SHALL BE PLACED SEPARATELY AND INSTALLED PRIOR TO ADJACENT ADA RAMPS AND/OR SIDEWALKS. CONCRETE LANDINGS SHALL HAVE A MINIMUM OF 24 HOURS OF CURE TIME PRIOR TO ADJACENT CONCRETE PLACEMENT.

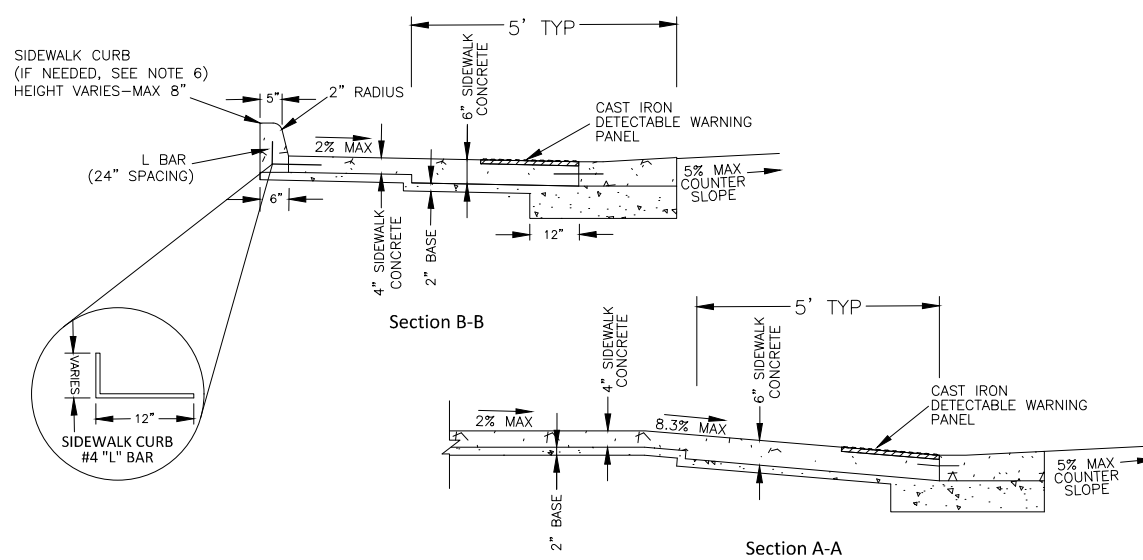
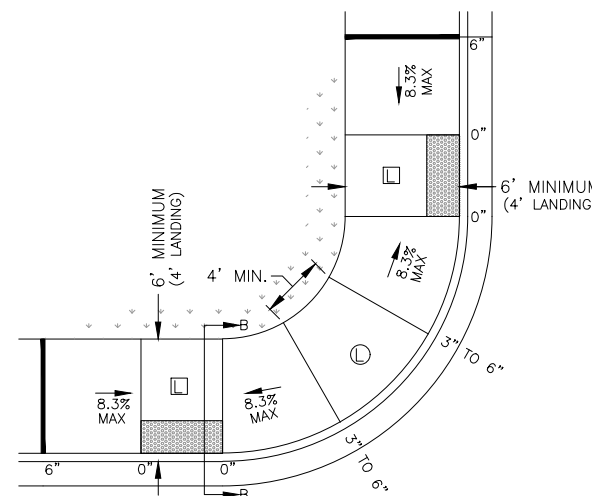
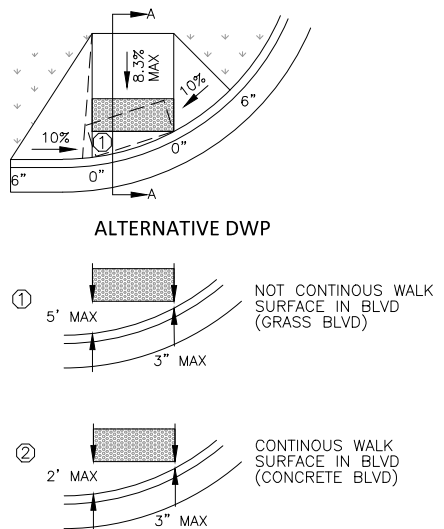
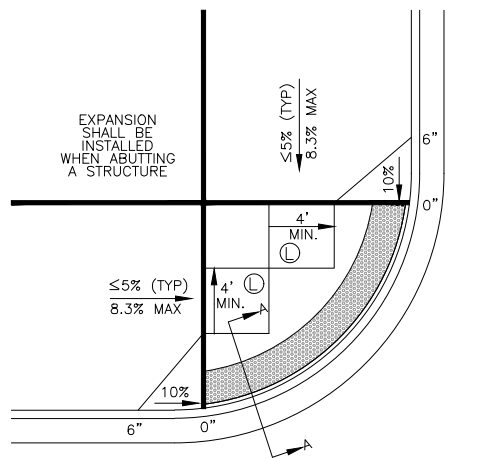
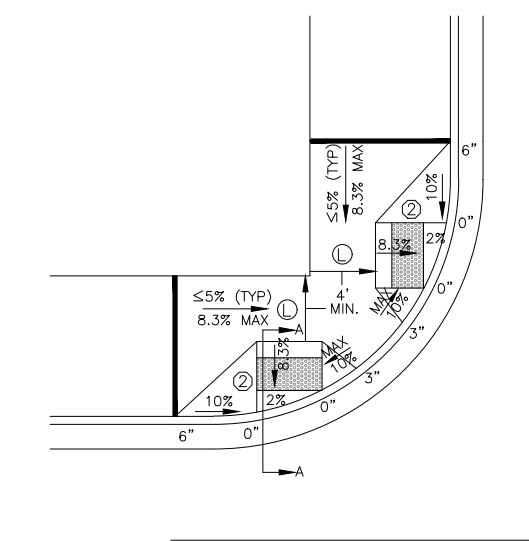
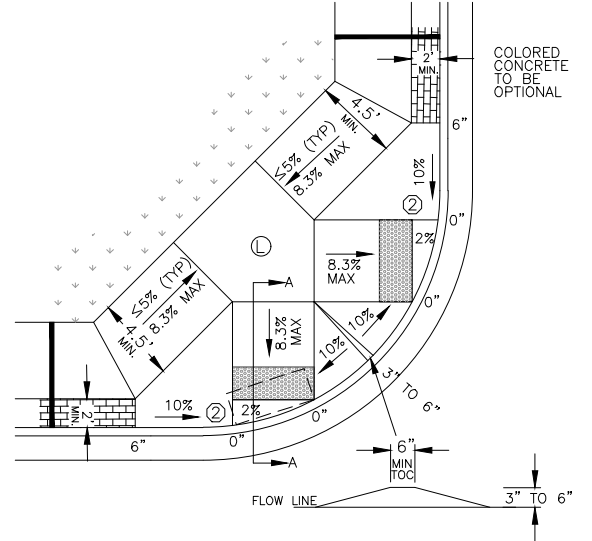
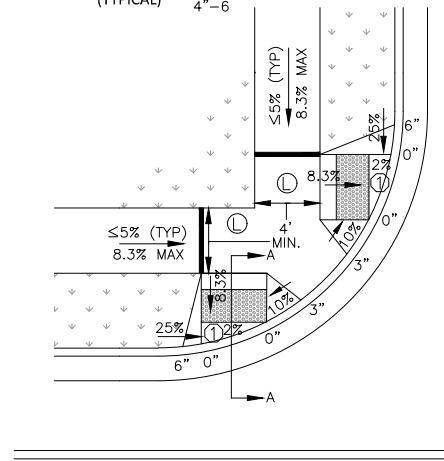
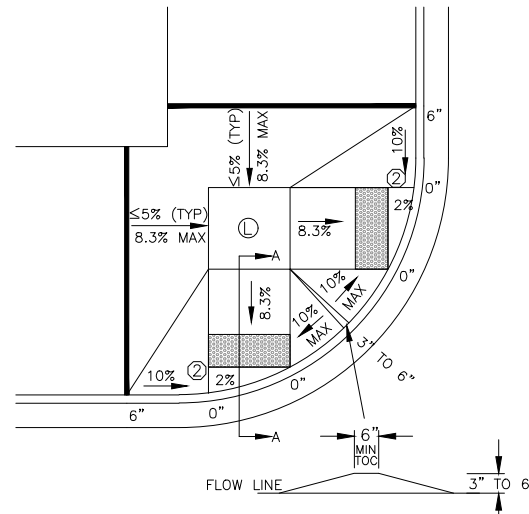
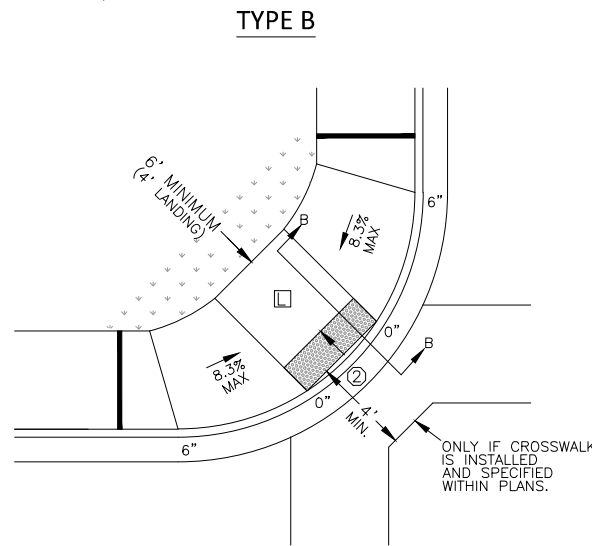
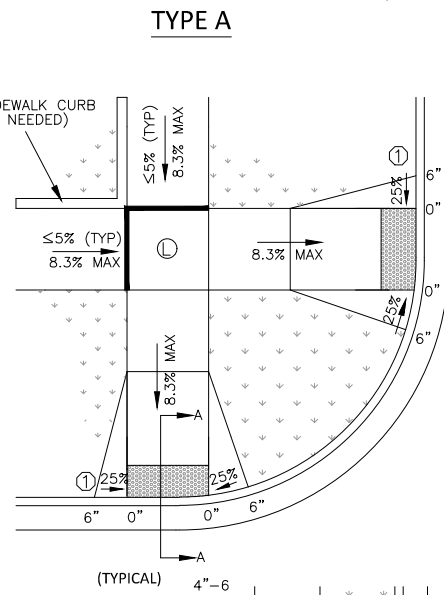

SIDEWALK RAMP CROSS-SECTIONS

REVISIONS		
③	②	①
<p>This document was originally issued and sealed by Kevin Gorder Registration Number PE-4285 on 4/11/2019 and the original document is stored in the Engineering Dept. at City Hall.</p>		
<p>Sidewalk ADA Standards</p>		
		<p>SHEET OF</p> <p>1 2</p>

05/03/19 10:43:12AM C:\Users\estumake\Documents\Drawing2.dwgDrawing2.dwg

SIDEWALK/BIKETRAIL DETAILS

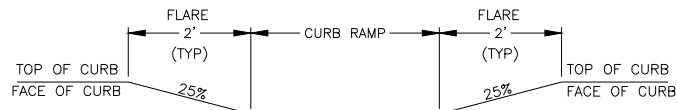

25% FLARES

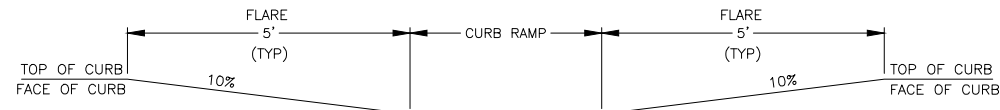

10% FLARES

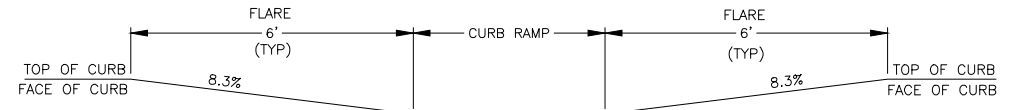

8.3% FLARES

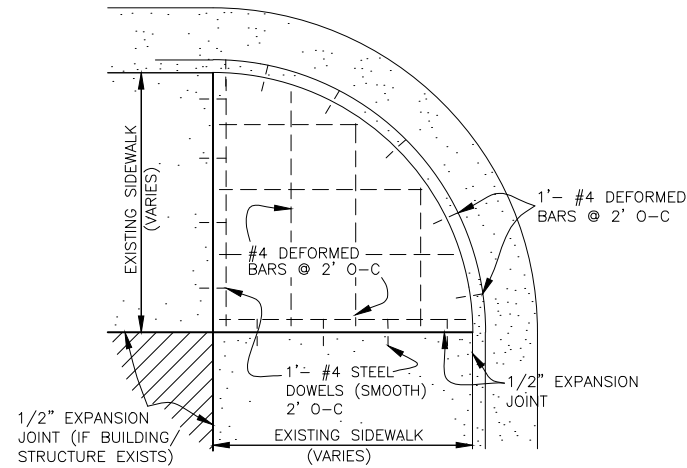

SIDEWALK REINFORCEMENT

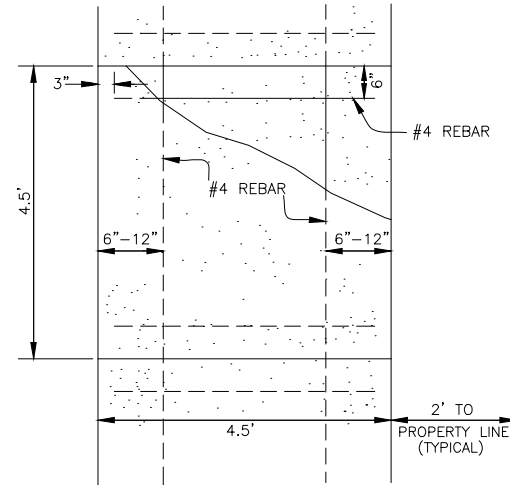

4.5' REINFORCEMENT

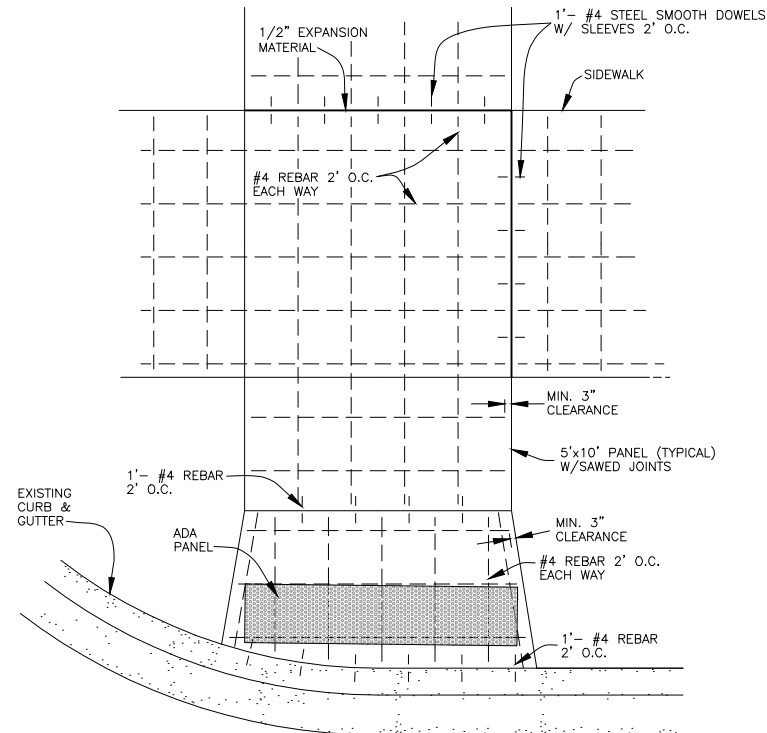

10' REINFORCEMENT

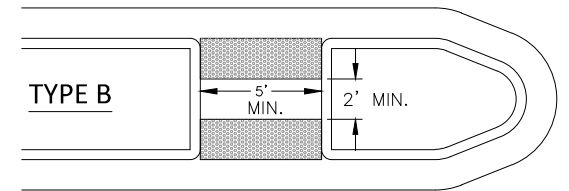
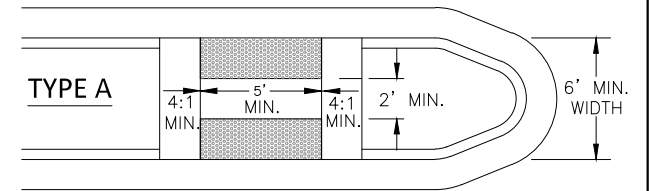

MEDIAN REFUGE ISLANDS (CUT-THROUGH)

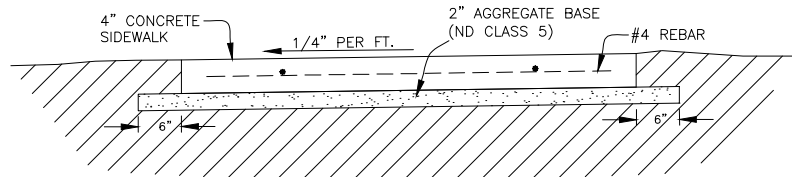

SIDEWALK CROSS-SECTION

SIDEWALK WIDTH	PANELS (L'xW')
6'	5'x6'
8'	4.5'x4'
10'	5'x5'

JOINT DIMENSION

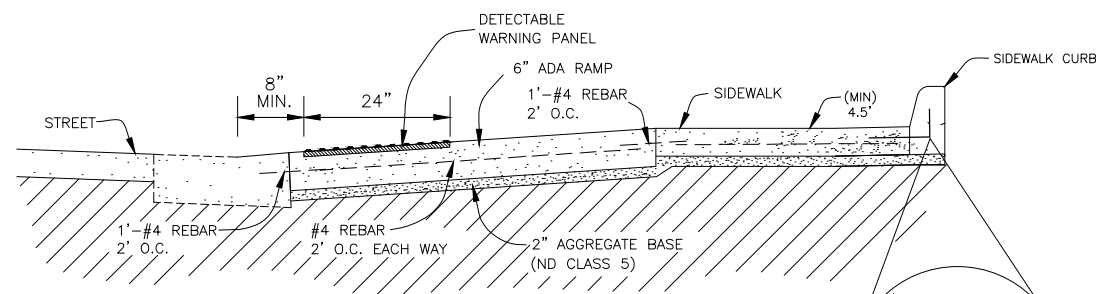

SIDEWALK REINFORCEMENT

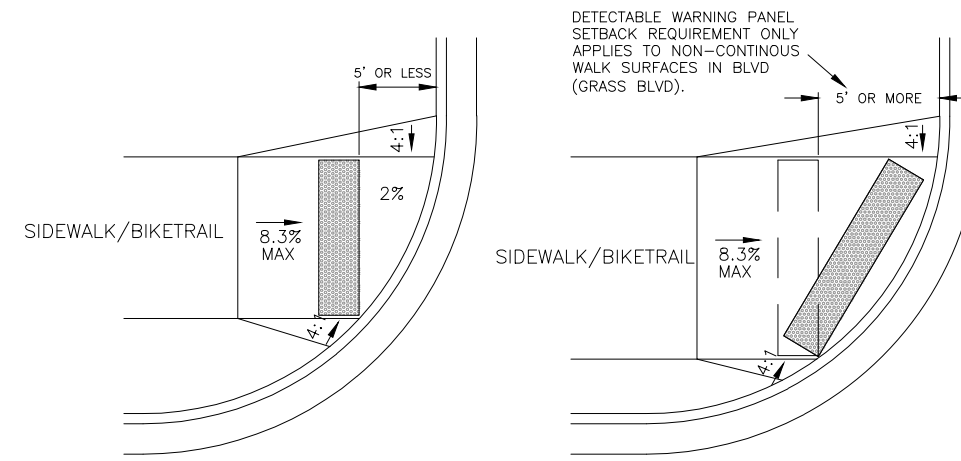
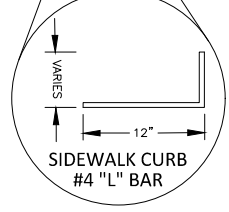

CONCRETE APRON FOR SIDEWALK/BIKETRAIL

REVISIONS		
③	②	①

This document was originally issued and sealed by Kevin Gorder Registration Number PE-4285 on 4/11/2019 and the original document is stored in the Engineering Dept. at City Hall.

Sidewalk ADA Standards		
THE CITY OF Fargo FAR MORE	SHEET	OF
	2	2

05/03/19 10:43:15AM C:\Users\csthumake\Documents\Drawing2.dwgDrawing2.dwg