

SIDEWALK RAMPS

TYPE A : GRASS BOULEVARD
 TYPE B : SIDEWALK ADJACENT TO STREET CURB
 TYPE C : CONTINUOUS CONCRETE IN BOULEVARD
 (TYPICALLY DOWNTOWN AREA)

TYPE A

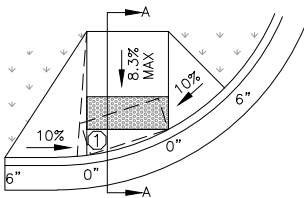
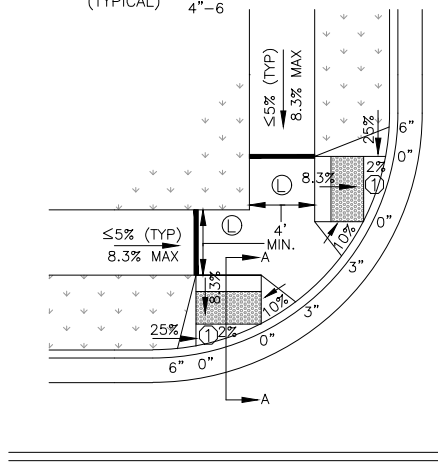
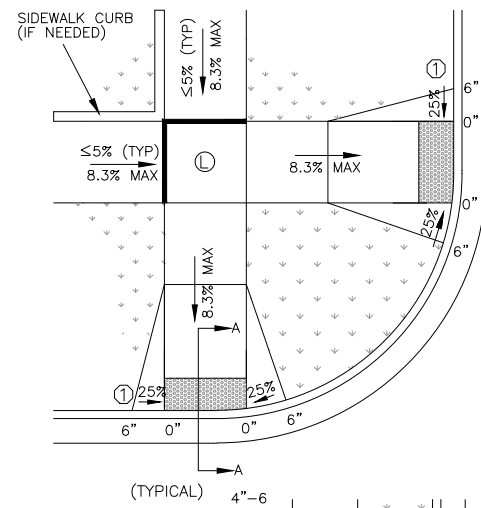

ALTERNATIVE DWP

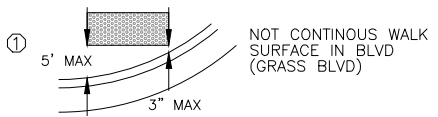

NOT CONTINUOUS WALK SURFACE IN BLVD (GRASS BLVD)

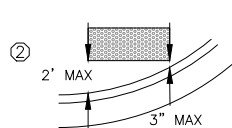

CONTINUOUS WALK SURFACE IN BLVD (CONCRETE BLVD)

TYPE B

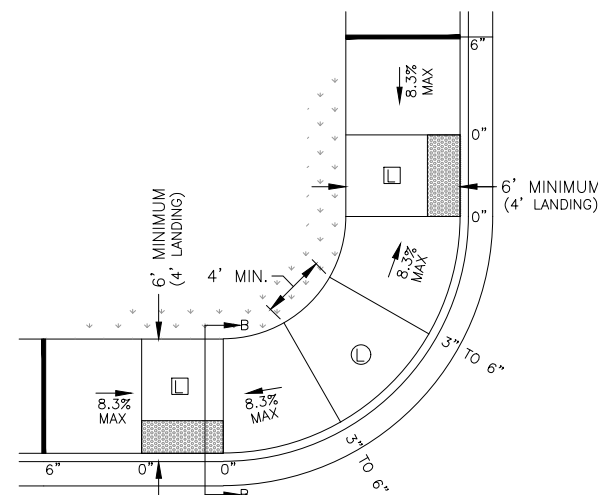
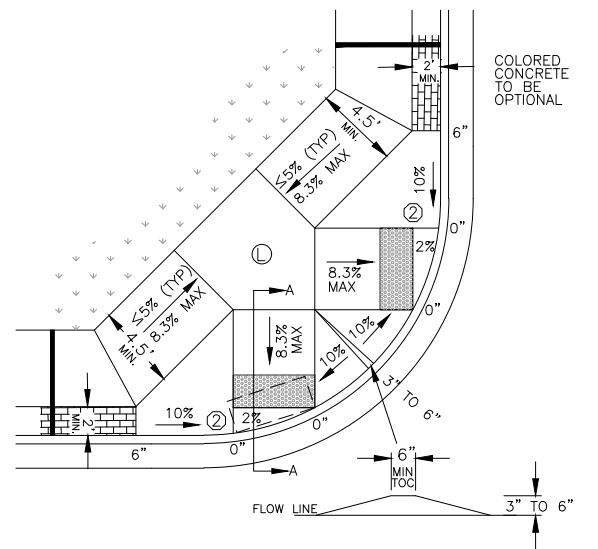
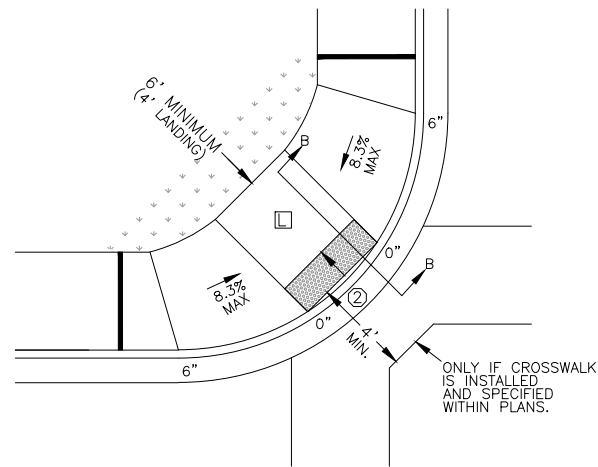

TYPE C

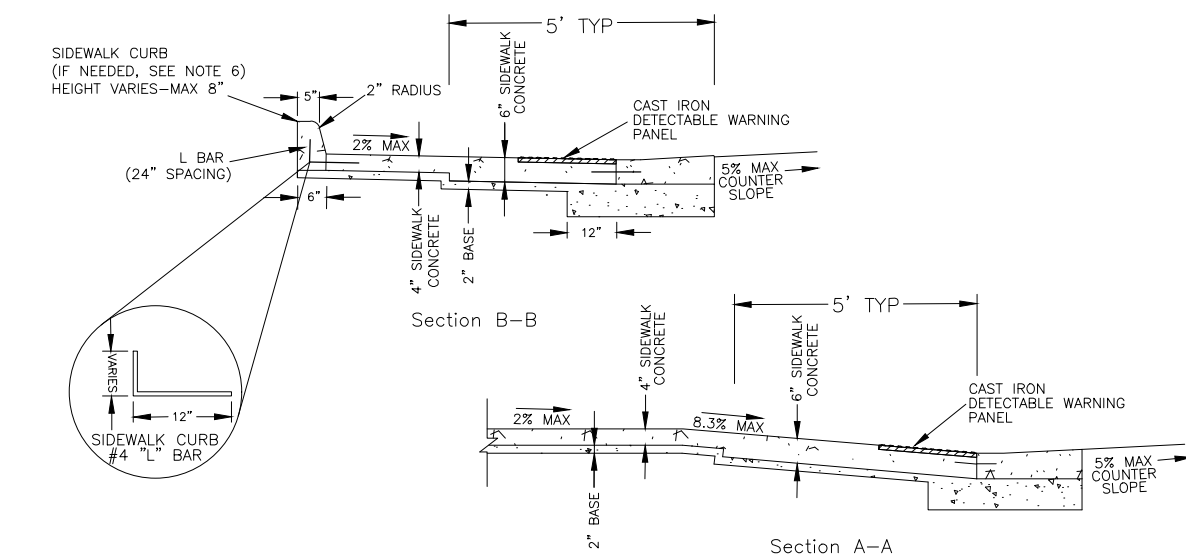
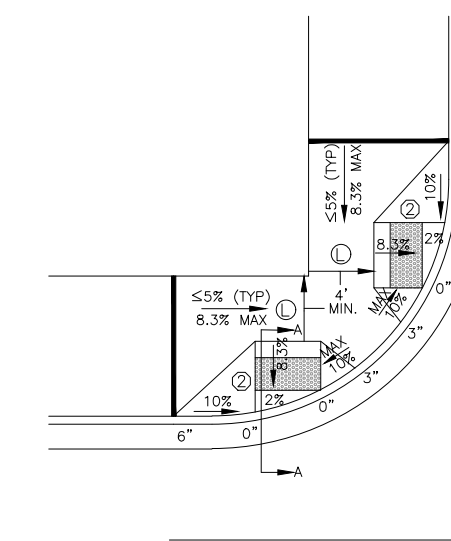
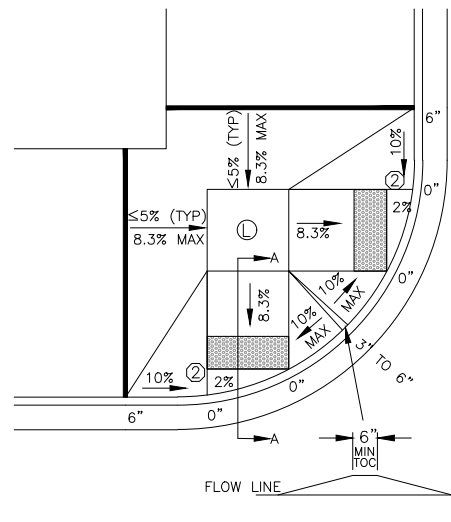

SIDEWALK RAMP CROSS-SECTIONS

LEGEND:

	DETECTABLE WARNING PANEL UNPAINTED CAST IRON
	GRASS
	COLORLED BRICK CONCRETE (MIN 2')
	UPPER LANDING 2% MAX
	LOWER LANDING 2% MAX
	0", 3", 4" OR 6" CURB HEIGHT
	1/2" EXPANSION (ALL EXPANSION SHALL BE SEALED WITH HOT POUR)
	20:1=5% 12:1=8.3% 10:1=10% 4:1=25%

- NOTES:
- RAMP WIDTH IS DEFINED AS THE USEABLE PORTION OF THE RAMP, EXCLUDING FLARES IF USED.
CURB RAMP WIDTH SHOULD MATCH THE EXISTING SIDEWALK WIDTH. 4' WIDTH MINIMUM.
RAMP WIDTH FOR SHARED-USE PATHS SHOULD MATCH THE EXISTING SHARED USE PATH WIDTH.
 - RAMP LENGTH SHALL BE MAXIMUM OF 15'.
ANY PORTIONS OF SIDEWALK BETWEEN THE DETECTABLE WARNING PANELS AND THE CURB SHALL HAVE A MAX 2% LONGITUDINAL GRADE.
 - LANDINGS SHALL BE A MINIMUM OF 4' X 4' AND SHALL HAVE A MAX 2% SLOPE IN ANY DIRECTION. LANDINGS ARE DESIRABLY 5' X 5' OR LARGER.
 - DETECTABLE WARNING PANELS SHALL MATCH THE RAMP WIDTH. RADIAL PANELS MAY ALSO BE USED. THE DETECTABLE WARNING PANEL MAY BE LOCATED WITHIN THE LOWER LANDING.
 - THE PEDESTRIAN ACCESS ROUTE SHALL BE CONTINUOUS 4' MIN. WIDTH. MAX 2% CROSS SLOPE APPLIES TO ALL CONCRETE, EXCLUDING FLARES.
 - LANDSCAPING IS PREFERRED TO MODIFY EXISTING GROUND SLOPE CHANGES AS NEEDED. IF NOT POSSIBLE, SUCH AS ADJACENT BUILDINGS, A VERTICAL CURB MAY BE USED AS SHOWN IN THE DETAIL BELOW. THE CURB WILL BE PAID FOR AT THE UNIT PRICE BID FOR THE ITEM "CURB - TYPE SW" PER LINEAL FOOT.
 - THE MAJORITY OF LINES SHOWN ON DETAILS INDICATE POINT OF DIFFERING GRADE CHANGES. ACTUAL JOINT DIMENSIONS MAY VARY IN FIELD.
 - LONGITUDINAL SLOPE ON SIDEWALK SHALL NOT EXCEED 5%. GENERALLY SIDEWALK GRADE IS ESTABLISHED BY THE ROADWAY GRADE. SIDEWALK SHALL NOT EXCEED 2% CROSS SLOPE.
 - CONCRETE LANDINGS SHALL BE PLACED SEPARATELY AND INSTALLED PRIOR TO ADJACENT ADA RAMPS AND/OR SIDEWALKS. CONCRETE LANDINGS SHALL HAVE A MINIMUM OF 24 HOURS OF CURE TIME PRIOR TO ADJACENT CONCRETE PLACEMENT.

ADDENDUM & CONSTRUCTION REVISIONS

③	②	①
---	---	---

SEAL

REGISTERED PROFESSIONAL ENGINEER
 KEVIN GORDON
 PE-4285
 DATE: 2/14/23
 NORTH DAKOTA

SW ADA RAMP DETAILS

Asphalt Mill & Overlay

Improvement District **PR-23-E1**

DESIGN BY: JMH	CHECKED BY: KOG
DRAWN BY: JMH	ORIG DATE: February 2023
Fargo FAR MORE	SECTION NO. 020
	SHEET NO. 1

03/02/23 08:25:16AM T:\Engineering\Projects\Current\PR-23-E1 Mill & Overlay\Plans&Specs\PR-23-E1_BP.dwg

SIDEWALK/BIKETRAIL DETAILS

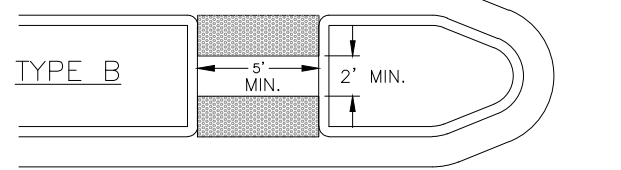
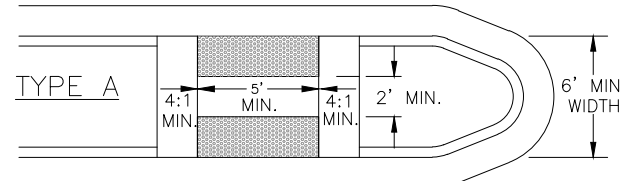
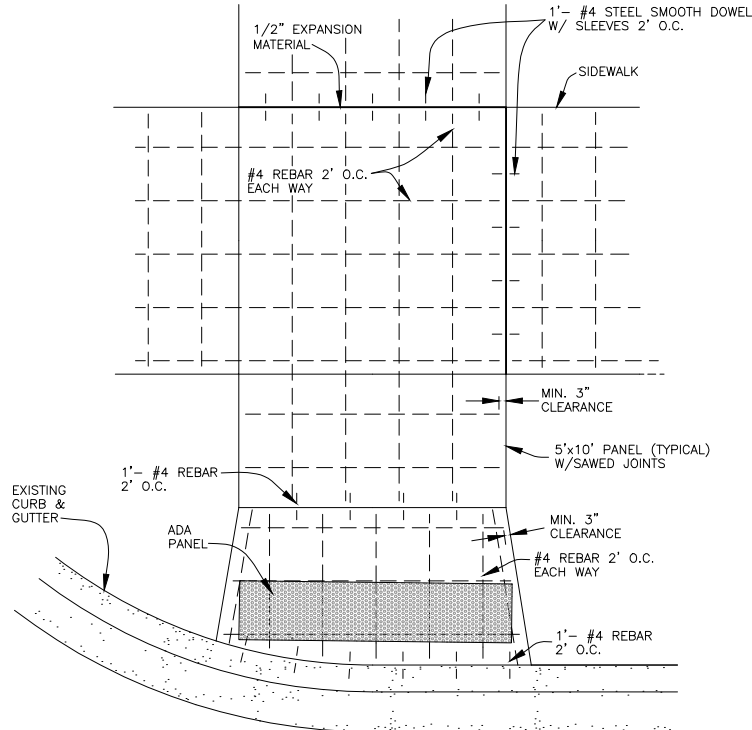
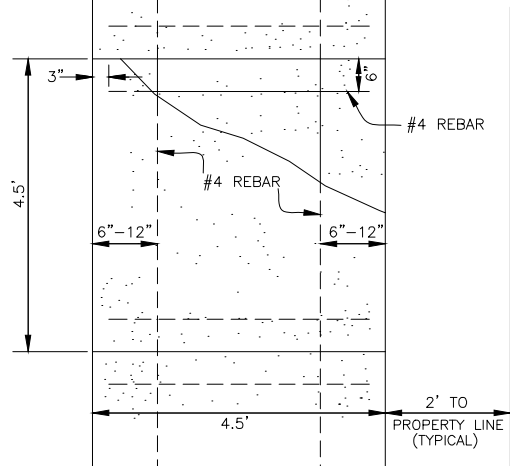
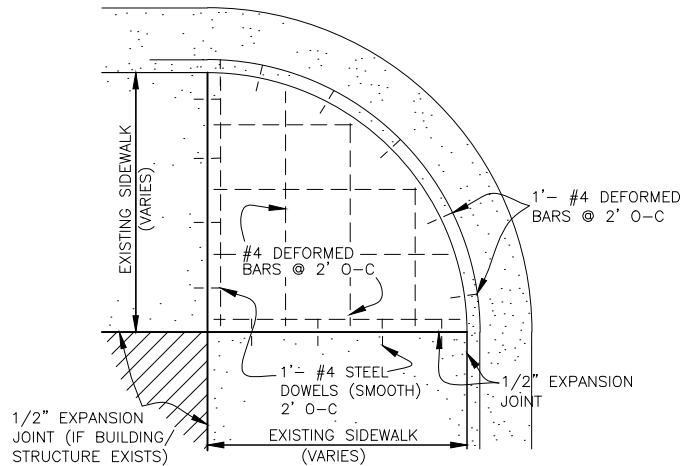
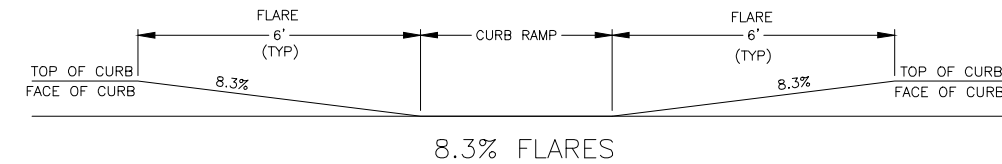
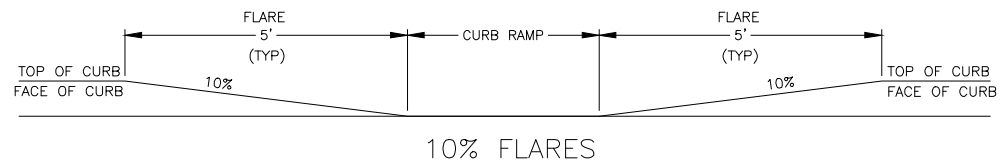
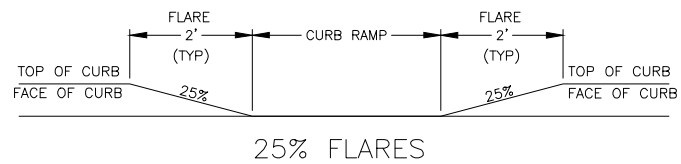

MEDIAN REFUGE ISLANDS (CUT-THROUGH)

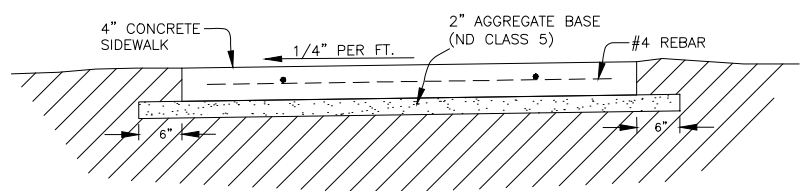

SIDEWALK WIDTH	PANELS (L'xW')
6'	5'x6'
8'	4.5'x4'
10'	5'x5'

JOINT DIMENSION

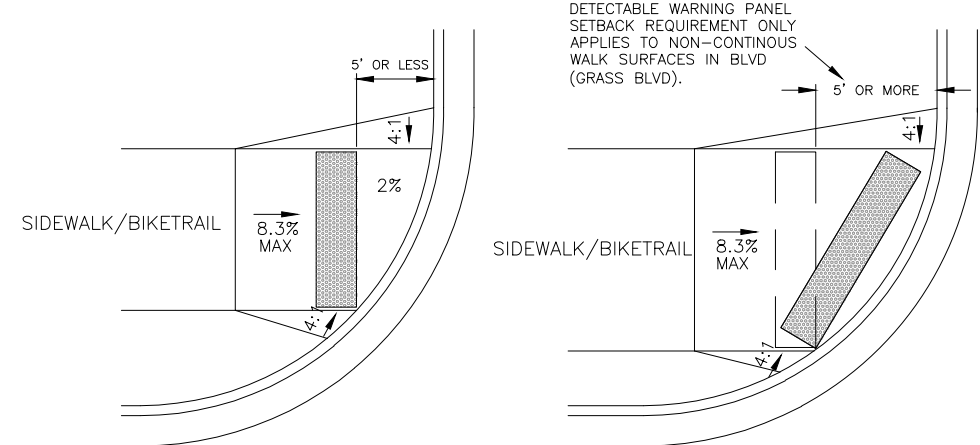
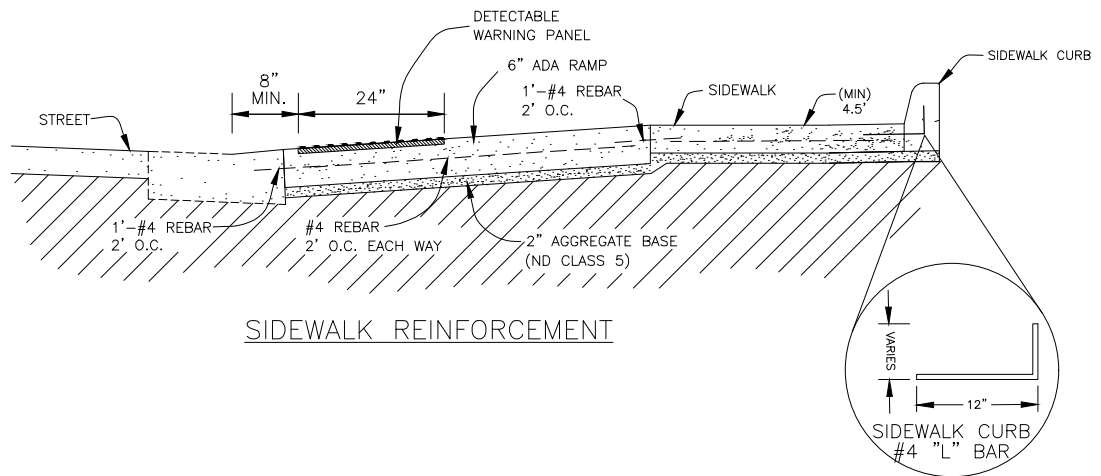

ADDENDUM & CONSTRUCTION REVISIONS		
③	②	①
SEAL		
SW ADA RAMP DETAILS		
Asphalt Mill & Overlay		
Improvement District PR-23-E1		
DESIGN BY: JMH	CHECKED BY: KOG	
DRAWN BY: JMH	ORIG DATE: February 2023	
		SECTION NO.
		SHEET NO.
		020
		2

03/02/23 08:25:49AM T:\Engineering\Projects\Current\PR-23-E1 Mill & Overlay\Plans&Specs\PR-23-E1_BP.dwg