



Item 6a.

Recommended Contracting Actions Summary

Date: October 27, 2016

Description	Company	Budget Estimate (\$)
Construction Change Orders		
6.a.2 WP-42A1/A3, 4th Street Pump Station Change Order 07 <ul style="list-style-type: none"> • Add Brackets for the Sanitary Overflow Piping • Add ST-4 Flared End with Grate • Add Sluice Gate Actuator Covers and Handwheel Nuts • No cost Change: Updated Grading Plan • Add 306 days to each original contract date for Demolition, Generator Building, Substantial Completion, and Final Completion for box culvert deficiency resolution • Add 3 days to Contract Milestones for asbestos wrapped pipe and pump house foundation removal work 	ICS, Inc.	7,689.91

Technical Advisory Group Recommendation

Meeting Date: 10/19/2016

RECOMMENDATION FOR ACTION:

The Technical Advisory Group has reviewed and recommend approval of the following Contract Action(s).

SUMMARY OF CONTRACTING ACTION:

The Owner’s Representative has reviewed and recommends the following Contract Action(s):

List description of Contract Action(s):

Description	Budget Estimate (\$)
-------------	----------------------

ICS, Inc.

Change Order #07

\$7,689.91

WP-42A.1/A.3, 4th Street Pump Station – Additional Brackets for Sanitary Overflow Piping, ST-4 Flared End With Grate, Sluice Gate Actuator Covers and Handwheel Nuts, Updated Lot Grading Plan, Contract Milestone, Project Substantial Completion, and Final Completion Date and Time Resets, and Time Added to Milestones 6, 7, and Project Substantial Completion for Asbestos Wrapped Pipe Disposal and Additional Foundation Removal.

Summary of Contracting History and Current Contract Action:

Original Agreement or Amendment	Budget (\$) Change	Previous Project Cost	Revised Project Cost	Project Start	Project Completion	Comments
WP-42A.1/A.3 contract	17,361,616.35	0.00	17,361,616.35	11-Dec-14	11-Nov-16	Awarded 4 th Street Pump Station and 2 nd Street South Floodwall
Change Order 1	268,555.24	17,361,616.35	17,630,171.59	11-Dec-14	11-Nov-16	Fargo Highrise parking lot modifications and other costs
Change Order 2	176,462.97	17,630,171.59	17,806,634.56	11-Dec-14	11-Nov-16	Unknown underground structures and other costs
Change Order 3	(10,570.93)	17,806,634.56	17,796,063.63	11-Dec-14	11-Nov-16	Deduct exterior electrical work and install fence, bollards, and lights at Fargo Highrise
Change Order 4	15,174.67	17,796,063.63	17,811,238.30	11-Dec-14	11-Nov-16	Time extensions and multiple cost adjustments for Engineer- and Owner-directed items.
Change Order 5	70,363.71	17,811,238.30	17,881,601.31	11-Dec-14	11-Nov-16	Last of suspended changes, sanitary overflow connection, T&M budget for ACM removal
Change Order 6	147,079.47	17,881,601.31	18,028,681.48	11-Dec-14	11-Nov-16	Last of suspended changes, erosion blanket, still wells, unsuitable materials and additional asbestos wrapped pipe.

Change Order 7	7,689.91	18,028,681.48	18,036,371.39	11-Dec-14	11-Nov-16	Sanitary Overflow Brackets, ST-4 Flared End with Grate, Sluice Gate Actuator Covers and 2" nuts, Updated Lot Grading Plan, Milestone and Project Completion Date Resets, and Time Additions.
----------------	----------	---------------	---------------	-----------	-----------	--

DISCUSSION

Change Order No. 7 increases the Contract Price by a total of **\$7,689.91**, replaces the Site Grading Plan, and increases the Contract Times by 309 days to the Demolition and Generator Building Milestones and Substantial Completion, and 306 days to Final Completion as listed below:

1. **Additional Brackets for the Sanitary Overflow Piping.** Sanitary Overflow Piping was approved in WCD 007 and Change Order 05 and has been installed in ST-6. However, after installation and review, the engineer recommends additional brackets be installed at the lower end of the pipes to counteract forces applied during high flow events. Stainless and non-stainless versions were considered. The stainless version is approximately \$500 more, would be sourced from out of the area with a 4 week lead time required. The city prefers the non-stainless option that can be sourced locally and has a much shorter lead time. Add \$2,125.48 to the Contract Price to accommodate furnishing and installing additional brackets in ST-4 and the adjacent Sanitary Sewer manhole. CH2M and the Engineer have reviewed this cost and found it reasonable.
2. **ST-4 Flared End with Grate.** The project was not originally designed with a grate at the south end of the inlet to ST-4. At the city’s request, a flared end with a grate will be installed to keep large material from entering the storm sewer system. Add \$3,522.33 to the Contract Price for this addition. The Owner’s Representative and Engineer have reviewed this cost and found it to be reasonable.
3. **Sluice Gate Actuator Covers and Handwheel Nuts.** Changes were made to the 2nd St. North Pump Station in the 42 A.2 Change Order 09. It was noted by the city that there were no lockable covers to prevent the public from operating the sluice gates, and a 2 inch nut adapter could be added to operate the gates more easily with a portable drill. The city has requested that the same modifications be installed at the 4th St. Pump Station Sluice Gates. Add \$2042.10 to the Contract Price to furnish and install these items. The Owner’s Representative has reviewed this price and considers it reasonable.
4. **Plan Updates.** The Lot Grading Plan has been updated. This replaces the existing Sheet C-055-8 with the version dated 10/27/2016. This is a no cost change.
5. **Reset Contract Dates and Times.** During negotiation for a resolution to the box culvert deficiency, CH2M sent a letter to ICS on June 9, 2016 that explained how the Owner would adjust Contract milestones for the rest of the project. The adjustment would be based on the actual completion date of the pump station milestone, and extend all subsequent milestones according to their durations after the original pump station milestone.

For example, the duration between the original pump station milestone (November 13, 2015) and the demolition milestone (January 27, 2016) is 77 days. ICS actually achieved the pump station milestone on September 14, 2016. Therefore, the demolition milestone will be adjusted to 77 days after this date, or November 11, 2016. Following this method, all new milestones are shown in the table below:

Milestone	Original Date	Days After Pump Station	New Date
Pump Station	11/13/15	NA	9/14/16 (actual)
Demolition	1/27/16	77	11/30/16
Generator Building	9/5/16	297	7/8/17
Substantial Completion	9/5/16	297	7/8/17
Final Completion	11/11/16	364	9/13/17

All of these revised dates are 306 days later than the original dates. Add 306 days to each original date for Demolition, Generator Building, Substantial Completion, and Final Completion.

- Add Time to Contract Milestones.** Asbestos wrapped pipe was discovered during the removal of the twin 78" outfall pipes and the ductile iron force mains. Change Orders 04 and 05 contained budgets to dispose of them. The work was completed on a time and materials basis and now that it is complete, there was a two day delay related to their removal. Change Order 05 also included the removal of an additional 4 feet of old pumphouse foundation to be done on a time and materials basis. Now that this work has been completed, there was one additional day of delay. Add 3 days to the demolition, generator building, and Substantial Completion milestones.. The Owner's Representative has reviewed this schedule extension and considers it accurate.

ATTACHMENT(S):

Draft Change Order No. 7

Submitted by:



Tyler Smith, P.E.
 CH2M
 Project Manager
 Metro Flood Diversion Project

October 19, 2016

Date

Keith Berndt, Cass County Administrator
 Concur: _____ Non-Concur: _____

April Walker, Fargo City Engineer
 Concur: October 19, 2016 Non-Concur _____

Mark Bittner, Fargo Director of Engineering
 Concur: October 19, 2016 Non-Concur: _____

Jason Benson, Cass County Engineer
 Concur: October 19, 2016 Non-Concur _____

David Overbo, Clay County Engineer
 Concur: October 19, 2016 Non-Concur: _____

Robert Zimmerman, Moorhead City Engineer
 Concur: October 19, 2016 Non-Concur _____

Nathan Boerboom, Diversion Authority Project Manager
 Concur: October 19, 2016 Non-Concur: _____

Change Order No. 07

Date of Issuance:	<u>10/27/2016</u>	Effective Date:	<u>10/27/2016</u>
Owner:	<u>Metro Flood Diversion Authority</u>	Owner's Contract No.:	<u>WP-42A.1/A.3</u>
Owner's Representative:	<u>CH2M HILL Engineers, Inc.</u>	Owner's Representative Project No.:	<u>435534</u>
Contractor:	<u>ICS, Inc.</u>	Contractor's Project No.:	<u>1114</u>
Engineer:	<u>Houston-Moore Group, LLC</u>	Work Package No.:	<u>WP-42A.1/A.3</u>
Project:	<u>Fargo-Moorhead Area Diversion</u>	Contract Name:	<u>4th Street Pump Station and Gatewell and 2nd Street Floodwall South</u>

The Contract is modified as follows upon execution of this Change Order:

Description:

1. VARIOUS CHANGES:

Increase Contract Price by **\$7,689.91** by adding line item *0163, CO-07* as shown in the attached Change Order 7 Unit Price Schedule dated 10/14/2016, for the following modifications:

- a. Additional Brackets for Sanitary Overflow Piping – Add \$2,125.48 to accommodate the installation of additional brackets to the sanitary overflow connection installed in ST-6 on Change Order 05.
- b. ST-4 Flared End With Grate – Add \$3,522.33 to accommodate the installation of a flared end with a grate to ST-4.
- c. Sluice Gate Actuator Covers and Handwheel Nuts – Add \$2,042.10 to the Contract Price to furnish and install three lockable sluice gate actuator covers and three 2 inch handwheel nuts.

2. PLAN UPDATES:

Replace Lot Grading Plan Sheet C-055-8 with updated version dated 10/27/2016.

3. RESET CONTRACT DATES AND TIMES:

Make the following date changes to the Contract Times:

- a. Change the date of Milestone 6, Demolition of Existing Pump Stations, from January 29, 2016 to November 30, 2016.
- b. Change the date of Milestone 7, Generator Building and Floodwall South of 2nd Street, from September 5, 2016 to July 8, 2017.
- c. Change the date of Substantial Completion from September 5, 2016 to July 8, 2017.
- d. Change the Final Completion date from November 11, 2016 to September 13, 2017.

4. ADD TIME TO CONTRACT MILESTONES:

- a. Add 3 days to Milestones 6 and 7, and Project Substantial Completion for the disposal of asbestos coated pipe as approved in Change Orders 04 and 05, and removal of an additional 4 feet of old pump station foundation as approved in Change Order 05.

Attachments:

- Change Order 7 Unit Price Schedule dated 10/14/16
- Lot Grading Plan Sheet C-055-8 dated 10/27/2016

CHANGE IN CONTRACT PRICE	CHANGE IN CONTRACT TIMES
Original Contract Price: 17,361,616.35	Original Contract Times: Milestone 4.02.A.02: <u>November 1, 2015</u> Milestone 4.02.A.02a: <u>NA</u> Milestone 4.02.A.03: <u>July 31, 2015</u> Milestone 4.02.A.04: <u>August 20, 2015</u> Milestone 4.02.A.05: <u>November 13, 2015</u> Milestone 4.02.A.06: <u>January 26, 2016</u> Milestone 4.02.A.07: <u>September 5, 2016</u> Substantial Completion 4.02 B: <u>September 5, 2016</u> Final Completion 4.02 B: <u>November 11, 2016</u>
[Increase] [Decrease] from previously approved Change Orders No. <u>01</u> thru <u>06</u> : 667,065.13	[Increase] [Decrease] from previously approved Change Orders No. <u>01</u> thru <u>06</u> : Milestone 4.02.A.02: <u>30 days</u> Milestone 4.02.A.02.a: <u>14 days</u> Milestone 4.02.A.03: <u>29 days</u> Milestone 4.02.A.04: <u>29 days</u> Milestone 4.02.A.05: <u>30 days</u> Milestone 4.02.A.06: <u>0 days</u> Milestone 4.02.A.07: <u>0 days</u> Substantial Completion 4.02 B: <u>0 days</u> Final Completion 4.02 B: <u>0 days</u>
Contract Price prior to this Change Order: 18,028,681.48	Contract Times prior to this Change Order: Milestone 4.02.A.02: <u>December 1, 2015</u> Milestone 4.02.A.02a: <u>November 15, 2015</u> Milestone 4.02.A.03: <u>August 29, 2015</u> Milestone 4.02.A.04: <u>September 18, 2015</u> Milestone 4.02.A.05: <u>December 13, 2015</u> Milestone 4.02.A.06: <u>January 29, 2016</u> Milestone 4.02.A.07: <u>September 5, 2016</u> Substantial Completion 4.02 B: <u>September 5, 2016</u> Final Completion 4.02 B: <u>November 11, 2016</u>

[Increase] [Decrease] of this Change Order: <p style="text-align: right;">7,689.91</p>	[Increase] [Decrease] of this Change Order: Milestone 4.02.A.06: <u>309 days</u> Milestone 4.02.A.07: <u>309 days</u> Substantial Completion 4.02 B: <u>309 Days</u> Final Completion 4.02 B: <u>306 Days</u>
Contract Price incorporating this Change Order: <p style="text-align: right;">18,036,371.39</p>	Contract Times with all approved Change Orders: Milestone 4.02.A.02: <u>December 1, 2015</u> Milestone 4.02.A.02a: <u>November 15, 2015</u> Milestone 4.02.A.03: <u>August 29, 2015</u> Milestone 4.02.A.04: <u>September 18, 2015</u> Milestone 4.02.A.05: <u>December 13, 2015</u> Milestone 4.02.A.06: <u>December 3, 2016</u> Milestone 4.02.A.07: <u>July 11, 2017</u> Substantial Completion 4.02 B: <u>July 11, 2017</u> Final Completion 4.02 B: <u>September 13, 2017</u>

RECOMMENDED: By: _____ Owner's Representative (Authorized Signature) Title: <u>Construction Manager</u> Date: <u>10/27/2016</u>	ACCEPTED: By: _____ Owner (Authorized Signature) Title: _____ Date: _____	ACCEPTED: By: _____ Contractor (Authorized Signature) Title: _____ Date: _____
--	--	---

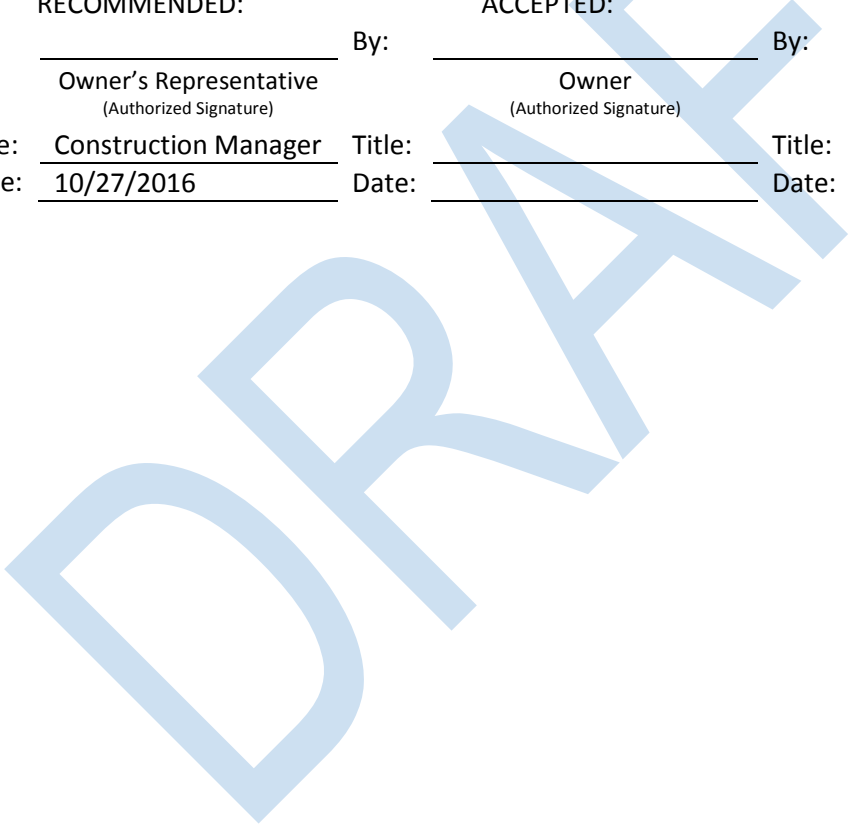

WP-42A.1/A.3
4th Street Pump Station and Gatewell - 2nd Street Floodwall South

Change Order 7 Unit Price Schedule
DATE: 10/14/2016



WP-42A.1/A.3 - 4th Street Pump Station and Gatewell - 2nd Street Floodwall South											
ITEM	DESCRIPTION	UNIT	Current Budget (thru CO-06)			Net Change			New Budget		
			QUANTITY	UNIT PRICE	AMOUNT	QUANTITY	UNIT PRICE	AMOUNT	QUANTITY	UNIT PRICE	AMOUNT
0001	Mobilization	LS	1	\$ 350,000.00	\$ 350,000.00	0	\$ -	\$ -	1	\$ 350,000.00	\$ 350,000.00
0002	Remove Sanitary Sewer Manhole	EA	2	\$ 1,100.00	\$ 2,200.00	0	\$ -	\$ -	2	\$ 1,100.00	\$ 2,200.00
0003	F&I Pipe SDR 26 - 10" Dia PVC	LF	145	\$ 70.00	\$ 10,150.00	0	\$ -	\$ -	145	\$ 70.00	\$ 10,150.00
0004	Remove Sanitary Sewer Pipe All Sizes All Types	LF	140	\$ 11.00	\$ 1,540.00	0	\$ -	\$ -	140	\$ 11.00	\$ 1,540.00
0005	Rem & Repl Sanitary Sewer Casting - Floating Manhole	EA	1	\$ 800.00	\$ 800.00	0	\$ -	\$ -	1	\$ 800.00	\$ 800.00
0006	Sanitary Sewer Manhole	EA	2	\$ 4,500.00	\$ 9,000.00	0	\$ -	\$ -	2	\$ 4,500.00	\$ 9,000.00
0007	Sanitary Sewer Exterior Drop Manhole	EA	1	\$ 12,000.00	\$ 12,000.00	0	\$ -	\$ -	1	\$ 12,000.00	\$ 12,000.00
0008	F&I 5" Hydrant	EA	2	\$ 6,000.00	\$ 12,000.00	0	\$ -	\$ -	2	\$ 6,000.00	\$ 12,000.00
0009	Salvage Hydrant	EA	2	\$ 600.00	\$ 1,200.00	0	\$ -	\$ -	2	\$ 600.00	\$ 1,200.00
0010	F&I Pipe C900 DR 18 - 6" Dia PVC	LF	479	\$ 60.00	\$ 28,740.00	0	\$ -	\$ -	479	\$ 60.00	\$ 28,740.00
0011	F&I Pipe C900 DR 18 - 10" Dia PVC	LF	416	\$ 65.00	\$ 27,040.00	0	\$ -	\$ -	416	\$ 65.00	\$ 27,040.00
0012	Remove Water Main Pipe All Sizes All Types	LF	697	\$ 11.00	\$ 7,667.00	0	\$ -	\$ -	697	\$ 11.00	\$ 7,667.00
0013	F&I Gate Valve 6" Dia	EA	5	\$ 2,200.00	\$ 11,000.00	0	\$ -	\$ -	5	\$ 2,200.00	\$ 11,000.00
0014	F&I Gate Valve 10" Dia	EA	3	\$ 4,000.00	\$ 12,000.00	0	\$ -	\$ -	3	\$ 4,000.00	\$ 12,000.00
0015	Watermain Fittings	LBS	4,157	\$ 12.00	\$ 49,884.00	0	\$ -	\$ -	4,157	\$ 12.00	\$ 49,884.00
0016	F&I Overflow Structure	EA	1	\$ 18,000.00	\$ 18,000.00	0	\$ -	\$ -	1	\$ 18,000.00	\$ 18,000.00
0017	F&I Manhole 4' Dia Reinf Conc	EA	3	\$ 5,000.00	\$ 15,000.00	0	\$ -	\$ -	3	\$ 5,000.00	\$ 15,000.00
0018	F&I Manhole 5' Dia Reinf Conc	EA	1	\$ 5,000.00	\$ 5,000.00	0	\$ -	\$ -	1	\$ 5,000.00	\$ 5,000.00
0019	F&I Manhole 6' Dia Reinf Conc	EA	2	\$ 20,000.00	\$ 40,000.00	0	\$ -	\$ -	2	\$ 20,000.00	\$ 40,000.00
0020	F&I Manhole 7' Dia Reinf Conc	EA	3	\$ 22,000.00	\$ 66,000.00	0	\$ -	\$ -	3	\$ 22,000.00	\$ 66,000.00
0021	F&I Manhole Type E Reinf Conc	EA	2	\$ 70,000.00	\$ 140,000.00	0	\$ -	\$ -	2	\$ 70,000.00	\$ 140,000.00
0022	F&I Manhole Type E Reinf Conc (ST-4)	EA	1	\$ 250,000.00	\$ 250,000.00	0	\$ -	\$ -	1	\$ 250,000.00	\$ 250,000.00
0023	F&I Manhole Type E Reinf Conc (ST-3)	EA	1	\$ 225,000.00	\$ 225,000.00	0	\$ -	\$ -	1	\$ 225,000.00	\$ 225,000.00
0024	F&I Manhole Type E Reinf Conc (ST-2)	EA	1	\$ 225,000.00	\$ 225,000.00	0	\$ -	\$ -	1	\$ 225,000.00	\$ 225,000.00
0025	F&I Manhole Type E Reinf Conc (ST-1)	EA	1	\$ 225,000.00	\$ 225,000.00	0	\$ -	\$ -	1	\$ 225,000.00	\$ 225,000.00
0026	Remove Storm Sewer Manhole	EA	5	\$ 600.00	\$ 3,000.00	0	\$ -	\$ -	5	\$ 600.00	\$ 3,000.00
0027	F&I Inlet - Manhole (MHI) 4' Dia Reinf Conc	EA	1	\$ 5,000.00	\$ 5,000.00	0	\$ -	\$ -	1	\$ 5,000.00	\$ 5,000.00
0028	F&I Inlet - Manhole (MHI) 6' Dia Reinf Conc	EA	1	\$ 15,000.00	\$ 15,000.00	0	\$ -	\$ -	1	\$ 15,000.00	\$ 15,000.00

WP-42A.1/A.3
4th Street Pump Station and Gatewell - 2nd Street Floodwall South

Change Order 7 Unit Price Schedule
DATE: 10/14/2016



WP-42A.1/A.3 - 4th Street Pump Station and Gatewell - 2nd Street Floodwall South											
ITEM	DESCRIPTION	UNIT	Current Budget (thru CO-06)			Net Change			New Budget		
			QUANTITY	UNIT PRICE	AMOUNT	QUANTITY	UNIT PRICE	AMOUNT	QUANTITY	UNIT PRICE	AMOUNT
0029	F&I Inlet - Single Box (SBI) Reinf Conc	EA	1	\$ 5,000.00	\$ 5,000.00	0	\$ -	\$ -	1	\$ 5,000.00	\$ 5,000.00
0030	F&I Inlet - Double Box (DBI) Reinf Conc	EA	1	\$ 7,000.00	\$ 7,000.00	0	\$ -	\$ -	1	\$ 7,000.00	\$ 7,000.00
0031	F&I Inlet - Special (SPI) Reinf Conc	EA	2	\$ 2,000.00	\$ 4,000.00	0	\$ -	\$ -	2	\$ 2,000.00	\$ 4,000.00
0032	Riprap (Outlet)	CY	410	\$ 125.00	\$ 51,250.00	0	\$ -	\$ -	410	\$ 125.00	\$ 51,250.00
0033	Box Culvert End Section with Grate	EA	1	\$ 25,000.00	\$ 25,000.00	0	\$ -	\$ -	1	\$ 25,000.00	\$ 25,000.00
0034	PLUG PIPE 33" DIA.	EA	1	\$ 1,500.00	\$ 1,500.00	0	\$ -	\$ -	1	\$ 1,500.00	\$ 1,500.00
0035	PLUG PIPE 72" DIA.	EA	1	\$ 3,300.00	\$ 3,300.00	0	\$ -	\$ -	1	\$ 3,300.00	\$ 3,300.00
0036	PLUG PIPE 78" DIA.	EA	2	\$ 4,500.00	\$ 9,000.00	0	\$ -	\$ -	2	\$ 4,500.00	\$ 9,000.00
0037	F&I Pipe 18" Dia Reinf Conc	LF	291	\$ 95.00	\$ 27,645.00	0	\$ -	\$ -	291	\$ 95.00	\$ 27,645.00
0038	F&I Pipe 24" Dia Reinf Conc	LF	86	\$ 120.00	\$ 10,320.00	0	\$ -	\$ -	86	\$ 120.00	\$ 10,320.00
0039	F&I Pipe 30" Dia Reinf Conc	LF	137	\$ 220.00	\$ 30,140.00	0	\$ -	\$ -	137	\$ 220.00	\$ 30,140.00
0040	F&I Pipe 36" Dia Reinf Conc	LF	8	\$ 250.00	\$ 2,000.00	0	\$ -	\$ -	8	\$ 250.00	\$ 2,000.00
0041	F&I Pipe 48" Dia Reinf Conc	LF	79	\$ 300.00	\$ 23,700.00	0	\$ -	\$ -	79	\$ 300.00	\$ 23,700.00
0042	F&I Pipe 54" Dia Reinf Conc	LF	79	\$ 800.00	\$ 63,200.00	0	\$ -	\$ -	79	\$ 800.00	\$ 63,200.00
0043	F&I Pipe 72" Dia Reinf Conc	LF	51	\$ 900.00	\$ 45,900.00	0	\$ -	\$ -	51	\$ 900.00	\$ 45,900.00
0044	F&I Pipe 12" Dia PVC	LF	99	\$ 120.00	\$ 11,880.00	0	\$ -	\$ -	99	\$ 120.00	\$ 11,880.00
0045	Remove Storm Sewer Pipe All Sizes All Types	LF	2,788	\$ 85.00	\$ 236,980.00	0	\$ -	\$ -	2,788	\$ 85.00	\$ 236,980.00
0046	30" Flapgate	EA	-	\$ 25,000.00	\$ -	0	\$ -	\$ -	-	\$ 25,000.00	\$ -
0047	54" Flapgate	EA	1	\$ 30,000.00	\$ 30,000.00	0	\$ -	\$ -	1	\$ 30,000.00	\$ 30,000.00
0048	F&I Pipe w/GB 30" Dia Reinf Conc	LF	240	\$ 1,100.00	\$ 264,000.00	0	\$ -	\$ -	240	\$ 1,100.00	\$ 264,000.00
0049	F&I Pipe w/GB 36" Dia Reinf Conc	LF	88	\$ 1,200.00	\$ 105,600.00	0	\$ -	\$ -	88	\$ 1,200.00	\$ 105,600.00
0050	F&I Pipe w/GB 54" Dia Reinf Conc	LF	19	\$ 2,000.00	\$ 38,000.00	0	\$ -	\$ -	19	\$ 2,000.00	\$ 38,000.00
0051	F&I Box Culvert 8'x5' Wide Reinf Conc Cast in Place with depth of fill 1' to 10'	LF	495	\$ 1,500.00	\$ 742,500.00	0	\$ -	\$ -	495	\$ 1,500.00	\$ 742,500.00
0052	F&I Box Culvert 8'x5' Wide Reinf Conc Cast in Place with depth of fill 10' to 31'	LF	128	\$ 2,800.00	\$ 358,400.00	0	\$ -	\$ -	128	\$ 2,800.00	\$ 358,400.00
0053	F&I Box Culvert 8'x5' Wide Reinf Conc Precast	LF	186	\$ 1,300.00	\$ 241,800.00	0	\$ -	\$ -	186	\$ 1,300.00	\$ 241,800.00
0054	Remove Pavement All Thicknesses All Types	SY	8,226	\$ 10.00	\$ 82,260.00	0	\$ -	\$ -	8,226	\$ 10.00	\$ 82,260.00
0055	Subgrade Preparation	SY	10,496	\$ 4.50	\$ 47,232.00	0	\$ -	\$ -	10,496	\$ 4.50	\$ 47,232.00
0056	F&I Woven Geotextile	SY	10,496	\$ 2.50	\$ 26,240.00	0	\$ -	\$ -	10,496	\$ 2.50	\$ 26,240.00

WP-42A.1/A.3
4th Street Pump Station and Gatewell - 2nd Street Floodwall South

Change Order 7 Unit Price Schedule
DATE: 10/14/2016



WP-42A.1/A.3 - 4th Street Pump Station and Gatewell - 2nd Street Floodwall South											
ITEM	DESCRIPTION	UNIT	Current Budget (thru CO-06)			Net Change			New Budget		
			QUANTITY	UNIT PRICE	AMOUNT	QUANTITY	UNIT PRICE	AMOUNT	QUANTITY	UNIT PRICE	AMOUNT
0057	F&I Class 5 Agg - 6" Thick	SY	5,578	\$ 10.00	\$ 55,780.00	0	\$ -	\$ -	5,578	\$ 10.00	\$ 55,780.00
0058	F&I Class 5 Agg - 7" Thick	SY	2,212	\$ 12.00	\$ 26,544.00	0	\$ -	\$ -	2,212	\$ 12.00	\$ 26,544.00
0059	F&I Class 5 Agg - 8" Thick	SY	733	\$ 13.00	\$ 9,529.00	0	\$ -	\$ -	733	\$ 13.00	\$ 9,529.00
0060	F&I Class 5 Agg - 12" Thick	SY	1,973	\$ 20.00	\$ 39,460.00	0	\$ -	\$ -	1,973	\$ 20.00	\$ 39,460.00
0061	F&I Crushed Conc - 6" Thick	SY	120	\$ 13.00	\$ 1,560.00	0	\$ -	\$ -	120	\$ 13.00	\$ 1,560.00
0062	F&I Curb & Gutter Standard (Type II)	LF	2,030	\$ 40.00	\$ 81,200.00	0	\$ -	\$ -	2,030	\$ 40.00	\$ 81,200.00
0063	Remove Curb & Gutter	LF	1,924	\$ 10.00	\$ 19,240.00	0	\$ -	\$ -	1,924	\$ 10.00	\$ 19,240.00
0064	F&I Pavement 6" Thick Reinf Conc	SY	3,744	\$ 66.00	\$ 247,104.00	0	\$ -	\$ -	3,744	\$ 66.00	\$ 247,104.00
0065	F&I Pavement 7" Thick Reinf Conc	SY	1,484	\$ 75.00	\$ 111,300.00	0	\$ -	\$ -	1,484	\$ 75.00	\$ 111,300.00
0066	F&I Pavement 9" Thick Doweled Conc	SY	1,519	\$ 90.00	\$ 136,710.00	0	\$ -	\$ -	1,519	\$ 90.00	\$ 136,710.00
0067	F&I Sidewalk 4" Thick Reinf Conc	SY	1,401	\$ 60.00	\$ 84,060.00	0	\$ -	\$ -	1,401	\$ 60.00	\$ 84,060.00
0068	Remove Sidewalk All Thicknesses All Types	SY	1,112	\$ 15.00	\$ 16,680.00	0	\$ -	\$ -	1,112	\$ 15.00	\$ 16,680.00
0069	Temp Construction Entrance	EA	4	\$ 1,700.00	\$ 6,800.00	0	\$ -	\$ -	4	\$ 1,700.00	\$ 6,800.00
0070	Traffic Control - Type 1	LS	1	\$ 26,000.00	\$ 26,000.00	0	\$ -	\$ -	1	\$ 26,000.00	\$ 26,000.00
0071	F&I Aggregate for Asph Pavement Class 29	TON	930	\$ 80.00	\$ 74,400.00	0	\$ -	\$ -	930	\$ 80.00	\$ 74,400.00
0072	F&I Asphalt Cement PG 58-28	GAL	13,385	\$ 4.00	\$ 53,540.00	0	\$ -	\$ -	13,385	\$ 4.00	\$ 53,540.00
0073	F&I Impressioned 4" Thick Reinf Conc	SY	72	\$ 220.00	\$ 15,840.00	0	\$ -	\$ -	72	\$ 220.00	\$ 15,840.00
0074	F&I Det Warn Panels Cast Iron	SF	109	\$ 70.00	\$ 7,630.00	0	\$ -	\$ -	109	\$ 70.00	\$ 7,630.00
0075	F&I Sign Assembly	EA	18	\$ 220.00	\$ 3,960.00	0	\$ -	\$ -	18	\$ 220.00	\$ 3,960.00
0076	Relocate Sign Assembly	EA	13	\$ 220.00	\$ 2,860.00	0	\$ -	\$ -	13	\$ 220.00	\$ 2,860.00
0077	F&I Engineering Grade	SF	23	\$ 30.00	\$ 690.00	0	\$ -	\$ -	23	\$ 30.00	\$ 690.00
0078	F&I Diamond Grade Cubed	SF	6	\$ 40.00	\$ 252.00	0	\$ -	\$ -	6	\$ 40.00	\$ 252.00
0079	F&I High Intensity Prismatic	SF	28	\$ 35.00	\$ 966.00	0	\$ -	\$ -	28	\$ 35.00	\$ 966.00
0080	F&I Flexible Delineator	EA	2	\$ 130.00	\$ 260.00	0	\$ -	\$ -	2	\$ 130.00	\$ 260.00
0081	F&I Grooved Plastic Film Message	SF	80	\$ 50.00	\$ 4,000.00	0	\$ -	\$ -	80	\$ 50.00	\$ 4,000.00
0082	F&I Grooved Plastic Film 4" Wide	LF	1,485	\$ 10.00	\$ 14,850.00	0	\$ -	\$ -	1,485	\$ 10.00	\$ 14,850.00
0083	F&I Grooved Plastic Film 24" Wide	LF	72	\$ 40.00	\$ 2,880.00	0	\$ -	\$ -	72	\$ 40.00	\$ 2,880.00
0084	Paint Epoxy Message	SF	32	\$ 20.00	\$ 640.00	0	\$ -	\$ -	32	\$ 20.00	\$ 640.00

WP-42A.1/A.3
4th Street Pump Station and Gatewell - 2nd Street Floodwall South

Change Order 7 Unit Price Schedule
DATE: 10/14/2016



WP-42A.1/A.3 - 4th Street Pump Station and Gatewell - 2nd Street Floodwall South											
ITEM	DESCRIPTION	UNIT	Current Budget (thru CO-06)			Net Change			New Budget		
			QUANTITY	UNIT PRICE	AMOUNT	QUANTITY	UNIT PRICE	AMOUNT	QUANTITY	UNIT PRICE	AMOUNT
0085	Paint Epoxy Line 4" Wide	LF	3,244	\$ 6.00	\$ 19,464.00	0	\$ -	\$ -	3,244	\$ 6.00	\$ 19,464.00
0086	Paint Epoxy Line 8" Wide	LF	234	\$ 10.00	\$ 2,340.00	0	\$ -	\$ -	234	\$ 10.00	\$ 2,340.00
0087	Paint Epoxy Line 24" Wide	LF	-	\$ 20.00	\$ -	0	\$ -	\$ -	-	\$ 20.00	\$ -
0088	Obliterate Pavement Markings	SF	182	\$ 35.00	\$ 6,370.00	0	\$ -	\$ -	182	\$ 35.00	\$ 6,370.00
0089	Temp Fence - Safety	LF	2,167	\$ 6.00	\$ 13,002.00	0	\$ -	\$ -	2,167	\$ 6.00	\$ 13,002.00
0090	Remove Fence	LF	202	\$ 27.00	\$ 5,454.00	0	\$ -	\$ -	202	\$ 27.00	\$ 5,454.00
0091	Temp Pumping	LS	1	\$ 95,000.00	\$ 95,000.00	0	\$ -	\$ -	1	\$ 95,000.00	\$ 95,000.00
0092	Clear & Grub	LS	1	\$ 15,000.00	\$ 15,000.00	0	\$ -	\$ -	1	\$ 15,000.00	\$ 15,000.00
0093	Remove Tree	EA	19	\$ 600.00	\$ 11,400.00	0	\$ -	\$ -	19	\$ 600.00	\$ 11,400.00
0094	Silt Fence - Standard	LF	784	\$ 4.00	\$ 3,136.00	0	\$ -	\$ -	784	\$ 4.00	\$ 3,136.00
0095	Floating Silt Fence	LF	93	\$ 30.00	\$ 2,790.00	0	\$ -	\$ -	93	\$ 30.00	\$ 2,790.00
0096	Sediment Control Log 6" to 8" Dia	LF	1,130	\$ 3.00	\$ 3,390.00	0	\$ -	\$ -	1,130	\$ 3.00	\$ 3,390.00
0097	Inlet Protection - New Inlet	EA	7	\$ 300.00	\$ 2,100.00	0	\$ -	\$ -	7	\$ 300.00	\$ 2,100.00
0098	Inlet Protection - Existing Inlet	EA	9	\$ 200.00	\$ 1,800.00	0	\$ -	\$ -	9	\$ 200.00	\$ 1,800.00
0099	Salvage Signal Standard	EA	1	\$ 300.00	\$ 300.00	0	\$ -	\$ -	1	\$ 300.00	\$ 300.00
0100	Lighting System	LS	1	\$ 20,000.00	\$ 20,000.00	0	\$ -	\$ -	1	\$ 20,000.00	\$ 20,000.00
0101	Propane Tanks Remove and Replace	LS	1	\$ 20,000.00	\$ 20,000.00	0	\$ -	\$ -	1	\$ 20,000.00	\$ 20,000.00
0102	Replace Unsalvagable Bollards	EA	40	\$ 1,000.00	\$ 40,000.00	0	\$ -	\$ -	40	\$ 1,000.00	\$ 40,000.00
0103	Revise Flashing Beacon System	LS	1	\$ 15,000.00	\$ 15,000.00	0	\$ -	\$ -	1	\$ 15,000.00	\$ 15,000.00
0104	Revise Traffic Control System	LS	1	\$ 20,000.00	\$ 20,000.00	0	\$ -	\$ -	1	\$ 20,000.00	\$ 20,000.00
0105	F&I Bus Shelter	EA	1	\$ 30,000.00	\$ 30,000.00	0	\$ -	\$ -	1	\$ 30,000.00	\$ 30,000.00
0106	F&I Sheet Piling - Steel	SF	168	\$ 65.00	\$ 10,920.00	0	\$ -	\$ -	168	\$ 65.00	\$ 10,920.00
0107	Topsoil - Strip	CY	5,870	\$ 5.00	\$ 29,350.00	0	\$ -	\$ -	5,870	\$ 5.00	\$ 29,350.00
0108	Topsoil - Spread	CY	2,784	\$ 5.00	\$ 13,920.00	0	\$ -	\$ -	2,784	\$ 5.00	\$ 13,920.00
0109	Embankment	CY	45,017	\$ 13.00	\$ 585,221.00	0	\$ -	\$ -	45,017	\$ 13.00	\$ 585,221.00
0110	Embankment Import	CY	8,617	\$ 22.00	\$ 189,574.00	0	\$ -	\$ -	8,617	\$ 22.00	\$ 189,574.00
0111	Excavation	CY	36,400	\$ 9.00	\$ 327,600.00	0	\$ -	\$ -	36,400	\$ 9.00	\$ 327,600.00
0112	Grading North of 2nd St S and West of 4th St S	LS	1	\$ 20,000.00	\$ 20,000.00	0	\$ -	\$ -	1	\$ 20,000.00	\$ 20,000.00

WP-42A.1/A.3
4th Street Pump Station and Gatewell - 2nd Street Floodwall South

Change Order 7 Unit Price Schedule
DATE: 10/14/2016



WP-42A.1/A.3 - 4th Street Pump Station and Gatewell - 2nd Street Floodwall South											
ITEM	DESCRIPTION	UNIT	Current Budget (thru CO-06)			Net Change			New Budget		
			QUANTITY	UNIT PRICE	AMOUNT	QUANTITY	UNIT PRICE	AMOUNT	QUANTITY	UNIT PRICE	AMOUNT
0113	Mulching Type 1 - Hydro	SY	16,703	\$ 0.50	\$ 8,351.50	0	\$ -	\$ -	16,703	\$ 0.50	\$ 8,351.50
0114	Seeding Type B	SY	16,703	\$ 0.35	\$ 5,846.05	0	\$ -	\$ -	16,703	\$ 0.35	\$ 5,846.05
0115	Overseeding	SY	33,405	\$ 0.25	\$ 8,351.25	0	\$ -	\$ -	33,405	\$ 0.25	\$ 8,351.25
0116	Weed Control Type B	SY	16,703	\$ 0.15	\$ 2,505.45	0	\$ -	\$ -	16,703	\$ 0.15	\$ 2,505.45
0117	Removable Floodwall	LS	1	\$ 120,000.00	\$ 120,000.00	0	\$ -	\$ -	1	\$ 120,000.00	\$ 120,000.00
0118	F&I Floodwall Reinf Bars - Steel	LB	63,445	\$ 1.10	\$ 69,789.50	0	\$ -	\$ -	63,445	\$ 1.10	\$ 69,789.50
0119	F&I Floodwall Reinf Bars - Epoxy Coated Steel	LB	59,852	\$ 1.30	\$ 77,807.60	0	\$ -	\$ -	59,852	\$ 1.30	\$ 77,807.60
0120	F&I Floodwall - Structural Conc	CY	828	\$ 1,100.00	\$ 910,800.00	0	\$ -	\$ -	828	\$ 1,100.00	\$ 910,800.00
0121	F&I Floodwall - Misc.	LS	1	\$ 225,000.00	\$ 225,000.00	0	\$ -	\$ -	1	\$ 225,000.00	\$ 225,000.00
0122	Demolition Pump Stations, Storm Sewers, Force Mains	LS	1	\$ 110,000.00	\$ 110,000.00	0	\$ -	\$ -	1	\$ 110,000.00	\$ 110,000.00
0123	Force Mains and Sump Pump Discharge	LS	1	\$ 600,000.00	\$ 600,000.00	0	\$ -	\$ -	1	\$ 600,000.00	\$ 600,000.00
0124	Pump Station - Structural and Architectural	LS	1	\$ 2,700,000.00	\$ 2,700,000.00	0	\$ -	\$ -	1	\$ 2,700,000.00	\$ 2,700,000.00
0125	Stormwater Pumps and Motors	LS	1	\$ 1,200,000.00	\$ 1,200,000.00	0	\$ -	\$ -	1	\$ 1,200,000.00	\$ 1,200,000.00
0126	Sump Pumps	LS	1	\$ 60,000.00	\$ 60,000.00	0	\$ -	\$ -	1	\$ 60,000.00	\$ 60,000.00
0127	Trash Racks and Miscellaneous Metals	LS	1	\$ 320,000.00	\$ 320,000.00	0	\$ -	\$ -	1	\$ 320,000.00	\$ 320,000.00
0128	Sluice Gates and Wall Thimbles	LS	1	\$ 250,000.00	\$ 250,000.00	0	\$ -	\$ -	1	\$ 250,000.00	\$ 250,000.00
0129	Generator Building - Structural and Architectural	LS	1	\$ 550,000.00	\$ 550,000.00	0	\$ -	\$ -	1	\$ 550,000.00	\$ 550,000.00
0130	Gatewell Structural	LS	1	\$ 870,000.00	\$ 870,000.00	0	\$ -	\$ -	1	\$ 870,000.00	\$ 870,000.00
0131	Gatewell - Miscellaneous Metals	LS	1	\$ 100,000.00	\$ 100,000.00	0	\$ -	\$ -	1	\$ 100,000.00	\$ 100,000.00
0132	Sheetpiling (Pump Station)	LS	1	\$ 1,200,000.00	\$ 1,200,000.00	0	\$ -	\$ -	1	\$ 1,200,000.00	\$ 1,200,000.00
0133	Health and Safety	LS	1	\$ 165,000.00	\$ 165,000.00	0	\$ -	\$ -	1	\$ 165,000.00	\$ 165,000.00
0134	Diesel Generator	LS	1	\$ 385,000.00	\$ 385,000.00	0	\$ -	\$ -	1	\$ 385,000.00	\$ 385,000.00
0135	Switchboard SWBDA, Motor Control Center MCLA, Automatic Transfer Switch, Panel HP1	LS	1	\$ 280,000.00	\$ 280,000.00	0	\$ -	\$ -	1	\$ 280,000.00	\$ 280,000.00
0136	Electrical-Interior	LS	1	\$ 105,000.00	\$ 105,000.00	0	\$ -	\$ -	1	\$ 105,000.00	\$ 105,000.00
0137	Electrical-Exterior	LS	1	\$ 138,066.65	\$ 138,066.65	0	\$ -	\$ -	1	\$ 138,066.65	\$ 138,066.65
0138	Instrumentation and Controls	LS	1	\$ 25,000.00	\$ 25,000.00	0	\$ -	\$ -	1	\$ 25,000.00	\$ 25,000.00
0139	Programming	LS	1	\$ 4,300.00	\$ 4,300.00	0	\$ -	\$ -	1	\$ 4,300.00	\$ 4,300.00
0140	HVAC - General	LS	1	\$ 20,000.00	\$ 20,000.00	0	\$ -	\$ -	1	\$ 20,000.00	\$ 20,000.00

WP-42A.1/A.3
4th Street Pump Station and Gatewell - 2nd Street Floodwall South

Change Order 7 Unit Price Schedule
DATE: 10/14/2016



WP-42A.1/A.3 - 4th Street Pump Station and Gatewell - 2nd Street Floodwall South											
ITEM	DESCRIPTION	UNIT	Current Budget (thru CO-06)			Net Change			New Budget		
			QUANTITY	UNIT PRICE	AMOUNT	QUANTITY	UNIT PRICE	AMOUNT	QUANTITY	UNIT PRICE	AMOUNT
0141	Plumbing General	LS	1	\$ 9,570.00	\$ 9,570.00	0	\$ -	\$ -	1	\$ 9,570.00	\$ 9,570.00
0142	Generator Accessories, Fuel Storage and Fuel System	LS	1	\$ 156,200.00	\$ 156,200.00	0	\$ -	\$ -	1	\$ 156,200.00	\$ 156,200.00
0143	Plug Pipe 30" Dia.	EA	1	\$ 860.00	\$ 860.00	0	\$ -	\$ -	1	\$ 860.00	\$ 860.00
0144	F&I Curb & Gutter Standard (Type I)	LF	281	\$ 43.00	\$ 12,083.00	0	\$ -	\$ -	281	\$ 43.00	\$ 12,083.00
0145	F&I Grooved Plastic Film 8" Wide	LF	224	\$ 13.00	\$ 2,912.00	0	\$ -	\$ -	224	\$ 13.00	\$ 2,912.00
0146	F&I Pipe 15" Dia Reinf Conc	LF	18	\$ 82.31	\$ 1,481.58	0	\$ -	\$ -	18	\$ 82.31	\$ 1,481.58
0147	Warming House Electrical Service	LS	1	\$ 49,834.89	\$ 49,834.89	0	\$ -	\$ -	1	\$ 49,834.89	\$ 49,834.89
0148	Bore 36" Pipe	LS	1	\$ 80,566.24	\$ 80,566.24	0	\$ -	\$ -	1	\$ 80,566.24	\$ 80,566.24
0149	Plug Pipe 6" Dia	EA	3	\$ 439.69	\$ 1,319.07	0	\$ -	\$ -	3	\$ 439.69	\$ 1,319.07
0150	F&I Flared End Section 48" Dia Reinf Conc	EA	1	\$ 5,119.28	\$ 5,119.28	0	\$ -	\$ -	1	\$ 5,119.28	\$ 5,119.28
0151	Connect Water Service	EA	2	\$ 2,643.38	\$ 5,286.76	0	\$ -	\$ -	2	\$ 2,643.38	\$ 5,286.76
0152	F&I Pipe 1" Dia Copper	LF	124	\$ 49.35	\$ 6,119.40	0	\$ -	\$ -	124	\$ 49.35	\$ 6,119.40
0153	F&I Pipe w/GB C900 DR 18 - 6" Dia PVC	LF	80	\$ 193.20	\$ 15,456.00	0	\$ -	\$ -	80	\$ 193.20	\$ 15,456.00
0154	Special Order Asbestos Fittings	EA	1	\$ 5,484.57	\$ 5,484.57	0	\$ -	\$ -	1	\$ 5,484.57	\$ 5,484.57
0155	Unknown Structures	LS	1	\$ 87,262.68	\$ 87,262.68	0	\$ -	\$ -	1	\$ 87,262.68	\$ 87,262.68
0156	CO-01 Field Changes	LS	1	\$ 14,998.89	\$ 14,998.89	0	\$ -	\$ -	1	\$ 14,998.89	\$ 14,998.89
0157	CO-02 Misc Requirements	LS	1	\$ 15,394.85	\$ 15,394.85	0	\$ -	\$ -	1	\$ 15,394.85	\$ 15,394.85
0158	Fargo Highrise Work	LS	1	\$ 6,362.42	\$ 6,362.42	0	\$ -	\$ -	1	\$ 6,362.42	\$ 6,362.42
0159	CO-04	LS	1	\$ 15,174.67	\$ 15,174.67	0	\$ -	\$ -	1	\$ 15,174.67	\$ 15,174.67
0160	Sanitary Overflow Connection	LS	1	\$ 10,363.71	\$ 10,363.71	0	\$ -	\$ -	1	\$ 10,363.71	\$ 10,363.71
0161	T&M Budget for Asbestos Pipe and Unsuitable Material Removal	LS	1	\$ 140,000.00	\$ 140,000.00	0	\$ -	\$ -	1	\$ 140,000.00	\$ 140,000.00
0162	CO-06	LS	1	\$ 67,079.47	\$ 67,079.47	0	\$ -	\$ -	1	\$ 67,079.47	\$ 67,079.47
0163	CO-07	LS	1		\$ -	0	\$ 7,689.91	\$ 7,689.91	1	\$ 7,689.91	\$ 7,689.91
42A.1/A.3 - TOTAL AMOUNT			CURRENT BUDGET			NET CHANGE			NEW BUDGET		
			\$ 18,028,681.48			\$ 7,689.91			\$ 18,036,371.39		



P.O. Box 13158 • Grand Forks, ND 58208-3158
(P) 701.775.8480 (F) 701.775.8479
www.icsgf.com

October 12, 2016

Tyler Smith
CH2M Hill
520 Main Avenue, Suite 601
Fargo, ND 58105

Re: Contract No. WP-42A.1/A.3 4th Street Pump House

Dear Ty,

As per AE2S' request Reiner has quoted the additional brackets in ST-6 as part of the bypass piping. See the revised enclosed quote (non stainless steel).

Reiner Contracting quote	\$ 2,024.27
ICS 5% markup	101.21
Total	\$ 2,125.48

In addition ICS requests one additional day added to the Milestone date for Pump Station Removal.

Please issue a Work Change Directive and add this work to your next change order.

Thanks.

Sincerely yours

A handwritten signature in blue ink, appearing to read "Jonathan R. Chose", is written over a blue horizontal line.

Jonathan R. Chose
Project Manager

REINER CONTRACTING INC.

21541 HWY. 7 WEST
HUTCHINSON, MN 55350

www.reinercontracting.com

Phone 320-587-9886

Fax 320-587-4847

10/12/2016

ICS

4838 Rocking Horse Circle

Fargo, ND 58104

RE: Price for additional bracket for bypass line

Bypass piping ST 6 to existing sanitary manhole

Brackets	\$1093.82
Crew Hours (3)	
2 labors @ \$94.51	\$ 567.06
1 foreman @ \$121.13	\$ 363.39
Price Bypass piping	\$ 2024.27

The first task of this change order is to run the blower in the sanitary manhole until the manhole is clear of all gases. The next task is to mount the mounting brackets to the walls. In ST 6 this is going to get extremely tight and the manhole steps may need to be removed in order to allow the piping where it needs to sit.

Sincerely,

Frank Little



P.O. Box 13158 • Grand Forks, ND 58208-3158
(P) 701.775.8480 (F) 701.775.8479
www.icsgf.com

October 14, 2016

Tyler Smith
CH2M Hill
520 Main Avenue, Suite 601
Fargo, ND 58105

Re: Contract No. WP-42A.1/A.3 4th Street Pump House

Dear Ty,

Following is a price to furnish and install the grate on the flared end section for ST-4.

Reiner Contracting quote	\$ 3,354.60
ICS 5% markup	167.73
Total	\$ 3,522.33

Please add this to Change Order #7.

Thanks.

Sincerely yours

A handwritten signature in blue ink, appearing to read "Jonathan R. Chose", is written over the typed name.

Jonathan R. Chose
Project Manager

REINER CONTRACTING INC.

21541 HWY. 7 WEST
HUTCHINSON, MN 55350

www.reinercontracting.com

Phone 320-587-9886

Fax 320-587-4847

10/13/2016

ICS

4838 Rocking Horse Circle

Fargo, ND 58104

RE: Grate for flared end section

48" flared end section

Material from Hancock	\$2543.11
Additional price for FES from pipe	\$ 501.34
<u>Crew Hours (1)</u>	
2 labors @ \$94.51	\$ 189.02
1 foreman @ \$121.13	\$ 121.13
Price for Grate for FES and additional cost for FES	\$ 3354.60

This would be for a grate for the 48" flared end section grate. This would include the price from the pipe to the FES cost.

Sincerely,

Frank Little



P.O. Box 13158 • Grand Forks, ND 58208-3158
(P) 701.775.8480 (F) 701.775.8479
www.icsgf.com

October 5, 2016

Tyler Smith
CH2M Hill
520 Main Avenue, Suite 601
Fargo, ND 58105

Re: Contract No. WP-42A.1/A.3 4th Street Pump House

Dear Ty,

Following is a price to furnish and install three actuator covers as per your spec sheet.

Auma Actuator Cover	\$ 383.10
One hour labor to install	65.00
15% markup	67.22
Total per each cover	\$ 515.32

There are two actuators on the gate well and one on the pump station for a total of three.

Please issue a Work Change Directive and add this work to your next change order.

Thanks.

Sincerely yours

A handwritten signature in blue ink, appearing to read "Jonathan R. Chose", is written over the typed name.

Jonathan R. Chose
Project Manager



P.O. Box 13158 • Grand Forks, ND 58208-3158
(P) 701.775.8480 (F) 701.775.8479
www.icsgf.com

October 19, 2016

Tyler Smith
CH2M Hill
520 Main Avenue, Suite 601
Fargo, ND 58105

Re: Contract No. WP-42A.1/A.3 4th Street Pump House

Dear Ty,

Following is a price to furnish and install three wheel locking devices as per your picture.

Auma Wheel locking device	\$ 78.81
One hour labor to install	65.00
15% markup	21.57
Total per each cover	\$ 165.38

There are two actuators on the gate well and one on the pump station for a total of three.

Please issue a Work Change Directive and add this work to your next change order.

Thanks.

Sincerely yours

A blue ink signature of Jonathan R. Chose, written in a cursive style, is positioned above the name and title.

Jonathan R. Chose
Project Manager

10/17/16 02:39:11PM H:\Fargo\JBN\7400\7438\12_7436_009\006-In-Town Levees Phase 1\CAD\2nd St S\Plans 90%\055_STORM C-005 C08-9-16.dwg

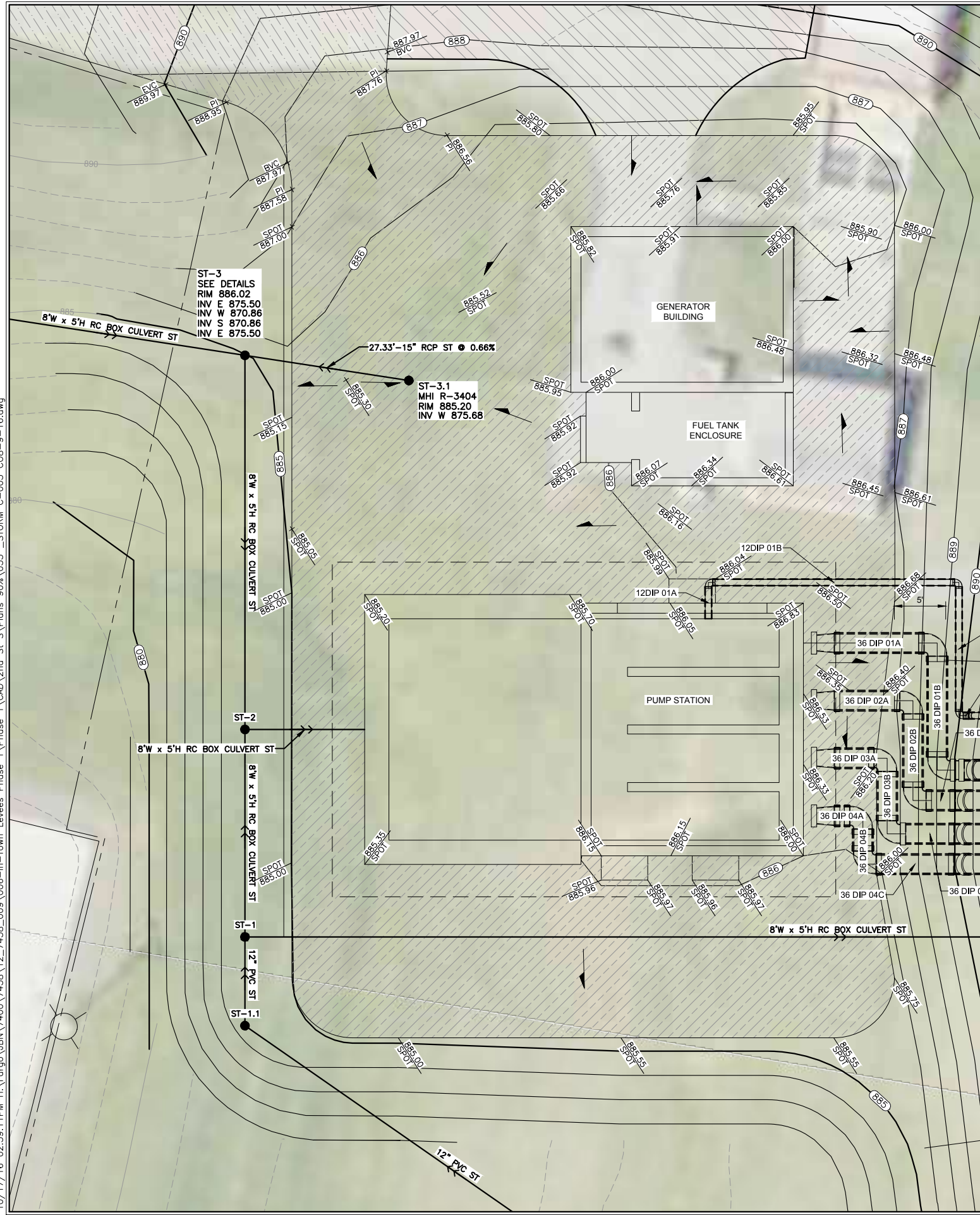

PIPE TABLE									
PIPE NAME	LENGTH	SLOPE	PIPE START NORTHING	PIPE START EASTING	START INV	PIPE END NORTHING	PIPE END EASTING	END INV	PIPE BEARING
12DIP 01A	5.28'	0.00%	461412.22	2897470.93	881.58	461417.37	2897469.80	881.58	N12° 21' 09.53"W
12DIP 01B	39.85'	0.00%	461418.23	2897470.35	881.58	461426.76	2897509.28	881.58	N77° 38' 50.08"E
12DIP 01C	20.52'	0.00%	461426.21	2897510.14	881.58	461406.16	2897514.53	881.58	S12° 21' 09.92"E
12DIP 01D	0.86'	0.00%	461405.61	2897515.39	881.58	461405.80	2897516.24	881.58	N77° 38' 44.70"E
12DIP 01E	58.83'	-41.42%	461405.80	2897516.24	881.58	461418.39	2897573.70	905.95	N77° 38' 28.01"E
12DIP 01F	35.83'	0.00%	461418.39	2897573.70	905.95	461426.05	2897608.70	905.95	N77° 39' 18.41"E
12DIP 01G	5.28'	0.00%	461425.50	2897609.56	905.95	461420.34	2897610.69	905.95	S12° 20' 41.70"E
36 DIP 01A	14.80'	0.00%	461412.75	2897492.07	880.43	461415.92	2897506.52	880.43	N77° 38' 50.17"E
36 DIP 01B	16.63'	0.00%	461414.27	2897509.12	880.43	461398.02	2897512.66	880.43	S12° 17' 12.54"E
36 DIP 01C	58.83'	-41.42%	461396.86	2897517.48	880.43	461409.44	2897574.94	904.80	N77° 38' 39.65"E
36 DIP 01D	33.50'	0.00%	461416.61	2897607.67	904.80	461409.44	2897574.94	904.80	S77° 39' 08.59"W
36 DIP 02A	10.80'	0.00%	461403.47	2897494.10	880.43	461405.78	2897504.65	880.43	N77° 38' 50.15"E
36 DIP 02B	12.13'	0.00%	461404.13	2897507.23	880.43	461392.28	2897509.82	880.43	S12° 21' 09.92"E
36 DIP 02C	4.82'	0.00%	461390.63	2897512.40	880.43	461391.66	2897517.11	880.43	N77° 38' 50.59"E
36 DIP 02D	58.84'	-41.42%	461391.66	2897517.11	880.43	461404.24	2897574.58	904.80	N77° 38' 44.60"E
36 DIP 02E	34.97'	0.00%	461411.72	2897608.74	904.80	461404.24	2897574.58	904.80	S77° 38' 59.02"W
36 DIP 03A	6.55'	0.00%	461394.19	2897496.13	880.43	461395.59	2897502.53	880.43	N77° 38' 49.81"E
36 DIP 03B	8.13'	0.00%	461393.94	2897505.11	880.43	461386.00	2897506.85	880.43	S12° 21' 09.97"E
36 DIP 03C	7.99'	0.00%	461384.53	2897510.30	880.43	461386.24	2897518.10	880.43	N77° 38' 50.50"E
36 DIP 03D	58.84'	-41.42%	461386.24	2897518.10	880.43	461398.83	2897575.57	904.80	N77° 38' 44.59"E
36 DIP 03E	35.16'	0.00%	461398.83	2897575.57	904.80	461406.35	2897609.92	904.80	N77° 38' 59.17"E
36 DIP 04A	2.55'	0.00%	461384.91	2897498.16	880.43	461385.46	2897500.65	880.43	N77° 38' 49.87"E
36 DIP 04B	3.63'	0.00%	461383.80	2897503.23	880.43	461380.26	2897504.01	880.43	S12° 21' 10.16"E
36 DIP 04C	12.83'	0.00%	461378.60	2897506.59	880.43	461381.35	2897519.12	880.43	N77° 38' 50.39"E
36 DIP 04D	58.84'	-41.42%	461381.35	2897519.12	880.43	461393.94	2897576.59	904.80	N77° 38' 44.06"E
36 DIP 04E	35.21'	0.00%	461393.94	2897576.59	904.80	461401.47	2897610.99	904.80	N77° 38' 58.55"E

This document was originally issued and sealed by Randy G. Engelstad Registration Number PE 6676 on 10/27/2016 and the original document is stored at CH2M Hill Engineering, Inc., Fargo, N.D.



2ND STREET/DOWNTOWN - IN-TOWN LEVEES
 4TH STREET PUMP STATION & 2ND STREET S FLOODWALL
 RED RIVER OF THE NORTH RIVER BASIN
 FARGO-MOORHEAD FLOOD RISK MANAGEMENT
 CASS COUNTY, NORTH DAKOTA
 LIFT STATION SITE PLAN

DATE:	11-17-14
REVISED:	5-14-15
REVISED:	7-10-15
REVISED:	10-27-16
RECORD:	
FILE NAME:	
PROJECT No.	WP-42A.3
DRAWN BY:	KAH
CHECKED BY:	MKR
PROJ. MANAGER:	KTD
PROJ. ENGINEER:	WBW

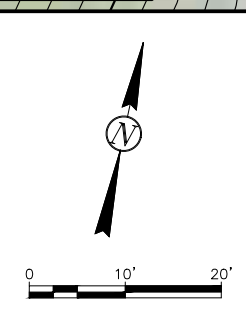

ELEVATION DATUM (VERTICAL CONTROL) NAVD 88 GEOID03
 COORDINATE SYSTEM (HORIZONTAL CONTROL) NAD 83 (1986) FARGO GROUND - US SURVEY FEET

C-055-8



Fargo Office
520 Main Avenue
Suite 601
Fargo ND 58103
Tel 701-566-5470

June 9, 2016

ICS, Inc.
Attention: Gary Bridgeford, Senior Vice President
P.O. Box 13158
Grand Forks, ND 58208-3158

Subject: Work Package 42A.1/A.3 – Proposed Resolution to Box Culvert Deficiency

Dear Mr. Bridgeford,

Thank you for your response dated May 25, 2016 that addressed the Diversion Authority's direction to correct the box culvert deficiency. It is good to hear that ICS is committed to working with CH2M and the Owner to solve this problem. We are therefore optimistic that we are close to a solution with the most equitable sharing of compromise by all parties.

CH2M is prepared to recommend to the Owner a course of action focused on installation of the vacuum line you previously reviewed and priced (attached for reference). While the Owner and City of Fargo would far prefer the box culvert meet the design requirement, an O&M consideration may provide an adequate solution for substantially less cost and time. But in exchange for making this compromise, the Owner will require cooperation from ICS. We are confident that a package consisting of the following points will be agreeable to the Owner and allow ICS to resume work in the shortest amount of time:

1. ICS shall install the vacuum line at their own cost. The unsatisfactory slope noted in NCN-010 will cause a build-up of sediment at the gatewell, but a means of facilitating its regular removal will be considered an acceptable corrective action to the construction deficiency.
2. Deduct \$600,000 from the Contract Price to accommodate future O&M costs. The City of Fargo would have performed one (1) maintenance event at the interface of the gatewell and box culvert per year to inspect and clean the flap gate seal just before winter. Now that the box culvert slope will cause pooling at the flap gate, the City believes they will need to perform four (4) additional maintenance events per year. This results in a total present value of \$600,000 based on a City cost of approximately \$3,000 per event (details attached) and the box culvert's operational service life of 50 years.

Please note that additional inspections and cleanings are not a function of how deep the pooling is, but the fact that *pooling occurs at all*. In other words, after major weather events flood the gatewell, the City must make sure the flap gate is still operational prior to future weather events. Therefore, since pooling is ultimately a result of the peak ICS installed at around station 3+15, and pooling would occur regardless of how much the gatewell has settled to date, splitting the O&M cost based on settlement is not applicable.

3. ICS shall effect repairs for NCNs 008 and 009 at their own cost. Under a vacuum line solution, full replacement of the box culvert is not necessary, and therefore the crack and joint separation issues must be fixed directly. Please reference our February 18, 2016 response to your notice of differing site conditions for why we don't consider these deficiencies to be a result of gatewell settlement.
4. Resumption of Liquidated Damages. We suspended LDs starting March 25, 2016 because we directed you not to perform wet testing of the pumps and you had completed all other prerequisite work on that date. Once the Owner approves this resolution, you will be able to proceed with pump testing at the point you were at on March 25, 2016. Therefore, we will resume assessing LDs from

the date you are authorized to continue work until the pump station is operational and you've met the requirements of the original November 13, 2015 milestone.

5. Adjustment to Liquidated Damages. The amount of LDs accrued to date (\$432,000) will be reduced to \$384,000 to account for the adjustments we stated in our February 17, 2016 letter. This is not a cap, however, and the future LDs discussed in paragraph 4 will be added to this amount.
6. New milestone dates. The required dates for demolition of the existing pump stations and the generator building/Substantial Completion will be adjusted based on the actual date you complete the pump station, as shown below:
 - a. There were 77 days between the original pump station milestone (November 13, 2015) and the demolition milestone (January 29, 2016). Therefore, the new demolition milestone will be 77 days after ICS actually completes the pump station.
 - b. There were ~~266~~^{297 PC} days between the original pump station milestone (November 13, 2015) and the generator building milestone/Substantial Completion (September 5, 2016). Therefore, the new generator building milestone/Substantial Completion will be 266 days after ICS actually completes the pump station.
7. Pump station operational. The pump station must be operational and online (i.e., storm sewer switch-over complete) no later than the end of August 2016.
8. Future project restrictions. ICS agrees not to bid or work on any City of Fargo, Diversion Authority, or Diversion-related (e.g., USACE projects supporting the Diversion) for a period of five (5) years.

Please review and provide your comments to me as soon as possible as CH2M is ready to proceed with recommending the Owner approve this resolution right away. I trust that a practical compromise that allows you to start work almost immediately, and at considerably less cost than a full replacement of the box culvert, will be in ICS's best interest as much as it is the Owner's.

Contact me at 208-771-1686 or tyler.smith@ch2m.com for questions regarding this letter.

Sincerely,

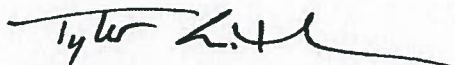

Tyler Smith, P.E.
Construction Manager
CH2M
Owner's Representative

Attachments:

1. Vacuum line design
2. City of Fargo O&M cost backup

c:	Travelers Casualty and Surety Company of America	Gregg Thielmann/HMG
	Gary Beeter/ICS	Randy Engelstad/HMG
	Nathan Boerboom/City of Fargo	Martin Nicholson/CH2M
	Nancy Morris/Erik R. Johnson & Associates	Randy Richardson/CH2M

From: [Jon Chose](#)
To: [Chitwood, Peter/FMH](#)
Subject: RE: Delays for CO 07 [EXTERNAL]
Date: Monday, October 17, 2016 8:51:50 AM

Thanks.

From: Peter.Chitwood@ch2m.com [mailto:Peter.Chitwood@ch2m.com]
Sent: Monday, October 17, 2016 8:32 AM
To: Jon Chose
Cc: Loren.Wagle@CH2M.com; Tyler.Smith@CH2M.com
Subject: RE: Delays for CO 07

Thanks Jon,

That's what everyone else's estimate was too. I'll put them in CO 7 which will get dropped into the pipeline today.

Peter

From: Jon Chose [mailto:jchose@icsgf.com]
Sent: Monday, October 17, 2016 7:13 AM
To: Chitwood, Peter/FMH <Peter.Chitwood@ch2m.com>
Cc: Wagle, Loren/FMH <Loren.Wagle@CH2M.com>; Smith, Tyler/FMH <Tyler.Smith@CH2M.com>
Subject: RE: Delays for CO 07 [EXTERNAL]

As per Frank Little at Reiner:

One day for the foundation removal and granular backfill.

Two days for the extra work on the asbestos pipe disposal.

Total of three days.

From: Peter.Chitwood@ch2m.com [mailto:Peter.Chitwood@ch2m.com]
Sent: Friday, October 14, 2016 1:10 PM
To: Jon Chose
Cc: Loren.Wagle@CH2M.com; Tyler.Smith@CH2M.com
Subject: Delays for CO 07

Hi Jon,

Now that the work is done, can you give me your assessment of the delays related to removing 4 extra feet of foundation and the asbestos pipe disposal? I talked to Loren and HMG to get their assessments of where you would be if we hadn't done that work. What is ICS'/Reiner's assessment? I'd like to put this on CO 07 by late Monday.

Thanks,