

# EDGEWOOD ESTATES INSET

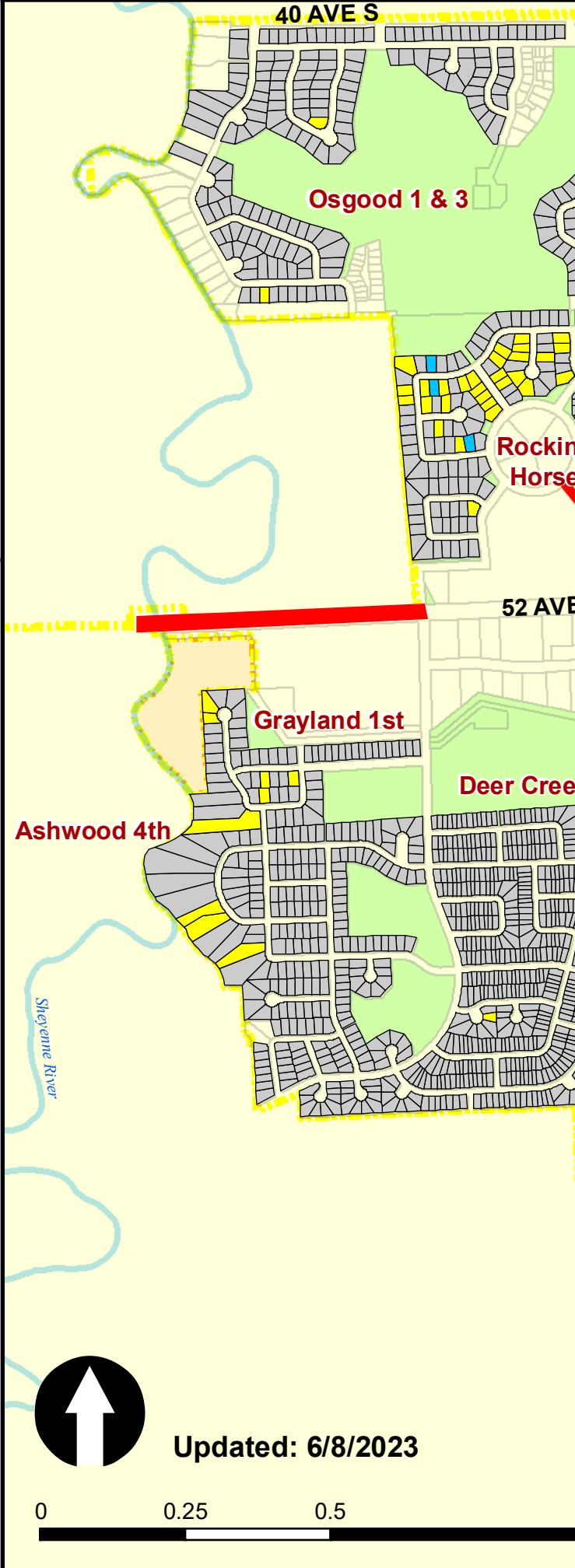
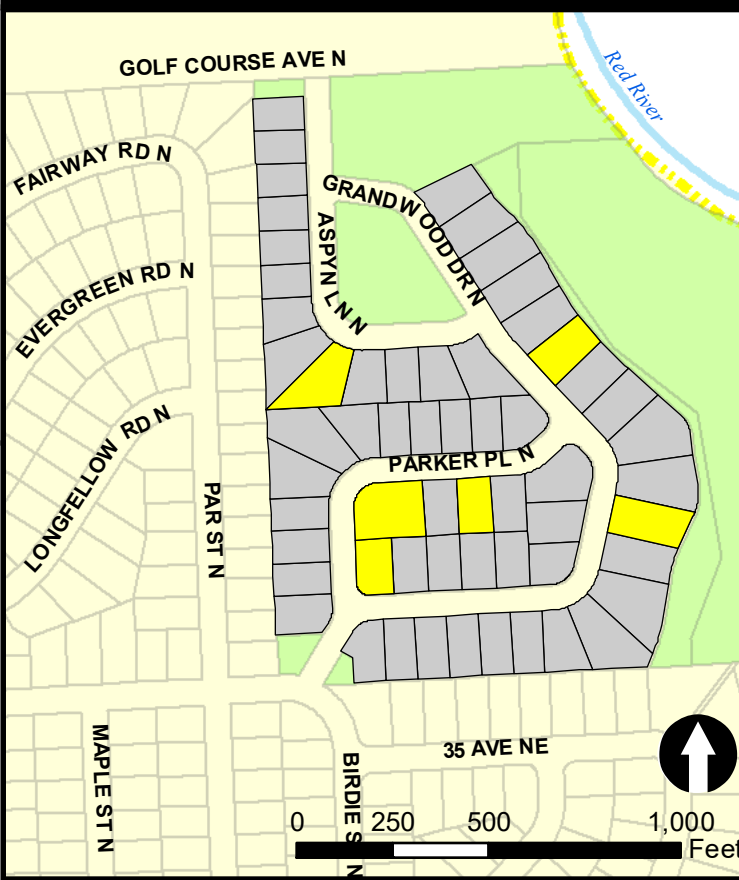

Subdivision	Year Approved	Total Lots	Built Lots	2023 Building Permits	Vacant Lots with Infrastructure	Vacant Lots 2023 Infrastructure	Vacant Lots No Infrastructure
Ashwood (4)	2013	38	35	0	3	0	0
Bison Meadows (1-2)	2016	190	187	3	0	0	0
Cottagewood (1-2)	2013-2015	105	68	0	37	0	0
Crofton Coves (1)	2013-2015	133	129	0	4	0	0
Deer Creek (1,3)	2010-2013	743	742	0	1	0	0
Eagle Pointe (1-3)	2012-2014	200	172	3	25	0	0
Eagle Valley (1,3-5)	2015-2021	178	174	0	4	0	0
Edgewood Estates (1-2)	2014-2021	58	52	0	6	0	0
Golden Valley (1-7)	2013-2023	333	216	8	57	52	0
Grayland's (1)	2018	62	56	0	6	0	0
Legacy I (4,6)	1998-2006	232	133	1	32	0	66
Madelyn's Meadows (1-4)	2018-2020	232	148	18	66	0	0
Maple Valley (1)	2007-2015	216	214	0	2	0	0
Meadow View	2022	143	6	16	30	91	0
MGB (1-2)	2010-2012	32	31	1	0	0	0
Osgood (1,3)	2003-2011	220	218	0	2	0	0
(The) Pines at the District	2013	134	94	1	39	0	0
Prairie Farms & Champions Gate (1)	2014	94	45	4	45	0	0
Rocking Horse (1-5)	2014-2018	182	127	4	51	0	0
Selkirk Place (1)	2020	43	1	0	42	0	0
Silverleaf (2-3)	2005-2011	14	12	1	1	0	0
Timber Creek (1-3)	2014	108	89	1	18	0	0
Valley View (1,4)	2013-2014	170	169	0	1	0	0
Valley View Estates (1-2)	2020-2021	160	112	19	29	0	0
Woodhurst	2014	13	10	0	3	0	0
<b>Total</b>		<b>4,033</b>	<b>3,240</b>	<b>80</b>	<b>504</b>	<b>143</b>	<b>66</b>

Table reflects building permits: January 1 - May 31, 2023  
Table updated: June 8, 2023

	% of Total Lots	% of Vacant Lots
Built Lots	80%	
2023 Building Permits	2%	
Vacant Lots	18%	100%
-Vacant Lots w/ Infrastructure	12%	71%
-Vacant Lots 2021 Infrastructure	4%	20%
-Vacant Lots No Infrastructure	2%	9%
Total Lots	100%	

# CITY OF FARGO

## 2023 RESIDENTIAL Building Permits & Vacant Lots

Single Family & Twin Homes



- 2023 Residential Building Permits
- Vacant lots (with Infrastructure)
- Vacant lots (No Infrastructure)
- 2023 CIP
- Preliminary Subdivisions
- Lots Permitted Prior to 2023
- CIP\_2023
- Interstate
- Drains
- Rivers
- Public Institutional Zones
- City Limits
- ET Boundary

User: jbrackl Date: Thursday, June 8, 2023 Path: M:\GIS\FargoData\GISAdmin\Map\_Productions\Permits\FargoVacantLotsAvailable\_062023.mxd